



Installation Instructions

Page 1 of 6

June 2004

Communications, Sirius Antenna

Version 2.0

Accessory
Development

These installation instructions supercede all previous versions.

SUBJECT

Sirius Antenna Installation Kit – P/N 84 11 0 150 524

MODEL

Cooper / Cooper-S (R50/R53): Select Vehicle Production 09/02 – 06/04*

** Not compatible with vehicles with optional Navigation system (SA609)*

SUGGESTED INSTALLATION TIME: 1.0 hour (Standard Audio System)
1.25 hours (H/K Audio System)

The instructions below are developed for MINI vehicles and are not be compared to any other existing instructions for vehicles other than MINI. No methods other than those specified in this document are to be used for installation in MINI vehicles. Left and right are determined from driver's seat.

Carefully read all instructions and supplements before proceeding with the installation. Reference should be made to TIS for instructions dealing with a stock part of the vehicle but not stated in detail in these instructions.

The instructions were complete and up to date at time of publication; however, changes to the vehicle or installation may have occurred. Please report any problems or changes noted with the installation to BMW Technical Hotline, along with VIN, date of manufacture and as much detail as possible.

NOTE: *Sirius antenna installation was designed to precede Sirius Receiver installation procedure.*

NOTE: *Performance of the Sirius antenna may be affected by roof racks and other large objects placed on the roof of MINI vehicles.*

★ ★ DO IT RIGHT THE FIRST TIME, ON TIME, EVERY TIME ★ ★

PARTS INFORMATION**Contents of Sirius Antenna Kit – 84 11 0 150 524**

Part Description	QTY	Part Number
Sirius Antenna for MINI	1	84 11 0 153 647
Antenna mounting nut	1	N/A
Terminal Block (Blue)	1	N/A
Terminal Block (White)	1	N/A
Terminal Lock (Violet)	2	N/A

Additional Required Parts:

MINI Sirius Receiver	84 11 0 150 535
MINI Receiver Install Kit	84 11 0 150 534

SPECIAL TOOLS

22mm Open-end socket (i.e. Snap-on S6176); Torque Wrench

PROCEDURE:

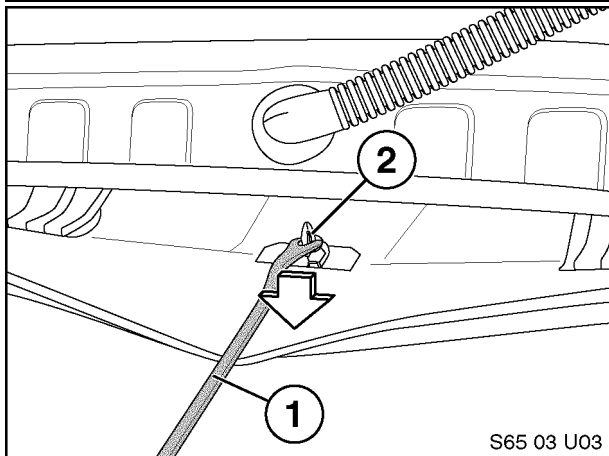
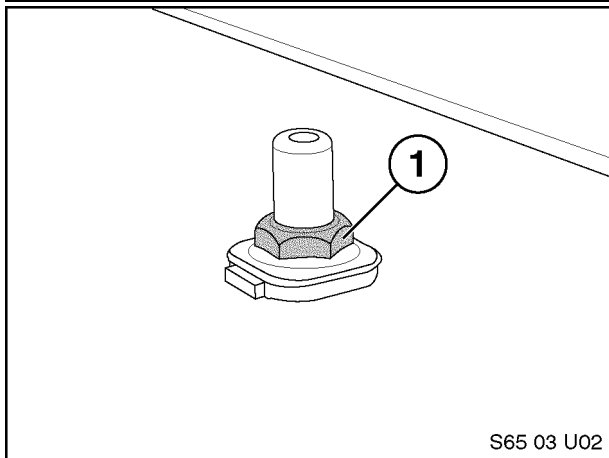
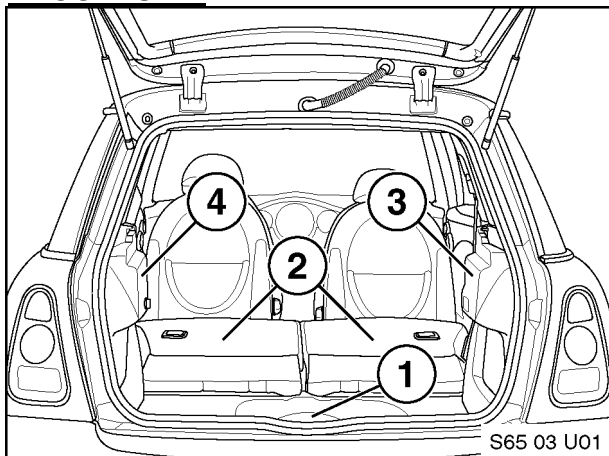

3

1. Remove rear sill panel (1).
2. Remove rear seatbacks and rear seat bottom (2).
3. Remove optional CD Changer if equipped. Remove right rear panel (3).

For vehicles equipped with HK audio system:

4. Remove left rear panel (4).
5. Remove antenna mast and cap. Remove antenna mounting nut (1).
6. Carefully pull away trunk hatch gasket from top half of hatch until just below C-pillar inner panels.
7. Remove ultrasonic sensor cover and ultrasonic sensor (if equipped with optional alarm system) from headliner. Remove Rear Sunroof trim ring (if equipped with Sunroof).
8. With a suitable pry tool (1), unclip headliner clip (2) from roof sheet metal.

Note: Take care to avoid damage to headliner material.

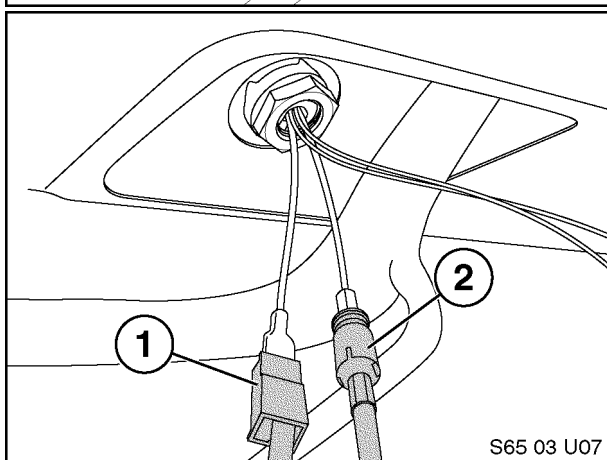
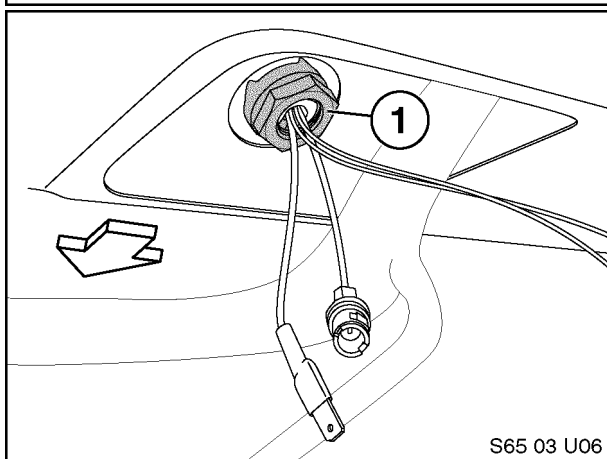
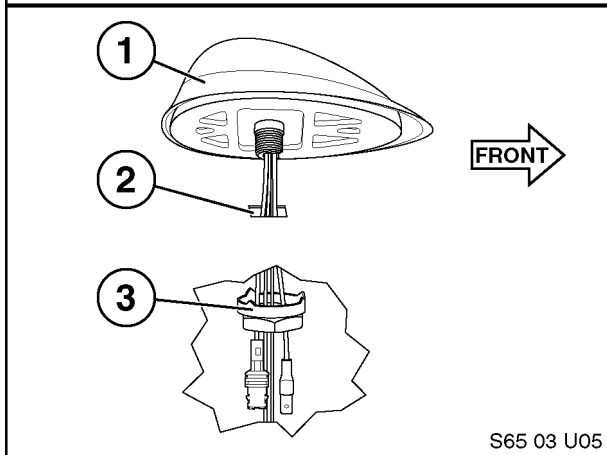
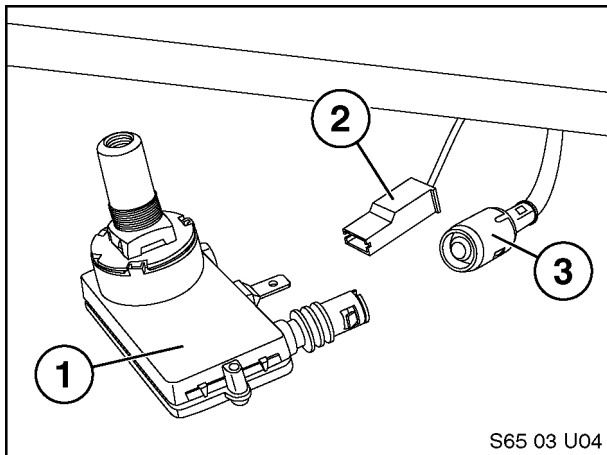

9. Remove antenna module (1) from roof and carefully disconnect spade (2) and coaxial (3) terminals following instructions available through TIS. The antenna module will not be reused.

10. Route cables from Sirius antenna (1) through hole in the roof sheet metal (2).

Note: *Arrow indicates front of vehicle.*

11. Below roof sheet metal route cables through center of antenna securing nut (3) as indicated.

12. Position securing nut (1) on threaded antenna post so tab on nut aligns with slot on threaded post.

Note: *arrow indicates front of vehicle.*

13. Using a 22mm open-ended socket and a torque wrench, thread securing nut onto post, taking care not to cross-thread or over-torque the nut. A torque of 6-7 Nm is recommended.

Warning: *Applying a torque greater than 7.0 Nm on the securing nut could damage the roof sheet metal and antenna.*

14. Connect the spade (1) and coaxial (2) terminals from Sirius antenna to existing terminals in the headliner from Step 9.

For vehicles equipped with standard audio system:

15. Route Sirius antenna cables (1) down the inside RH C-pillar as shown.

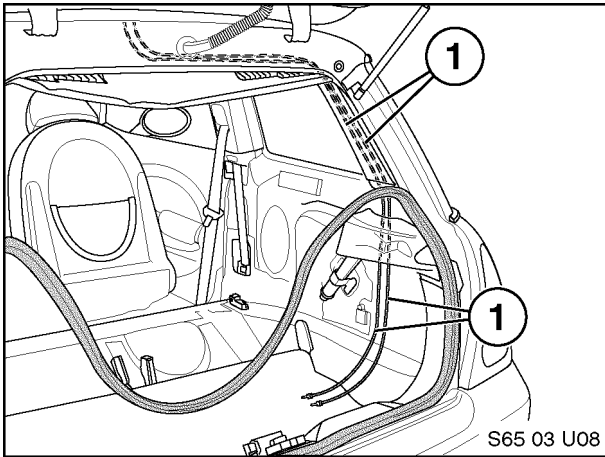

For vehicles equipped with HK Audio system:

16. Route Sirius antenna cables (1) down the inside LH C-pillar as shown.

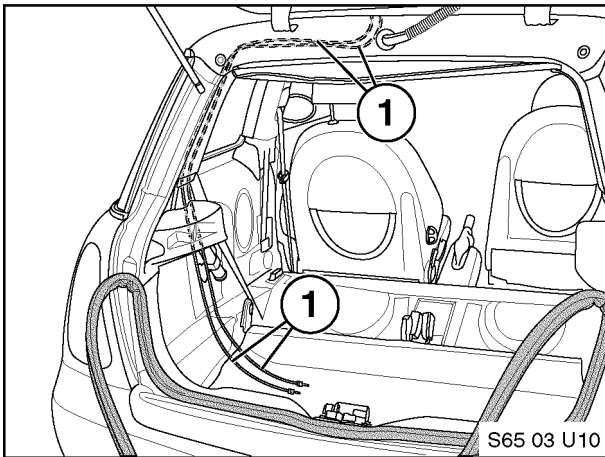

17. Once the cables have been routed into position, insert cable ends (1) into terminal blocks (2), then insert locks (3).

Note: Cable ends are labeled and color-coded to ensure the correct terminal block is used. Do not confuse cable ends or antenna will not function properly

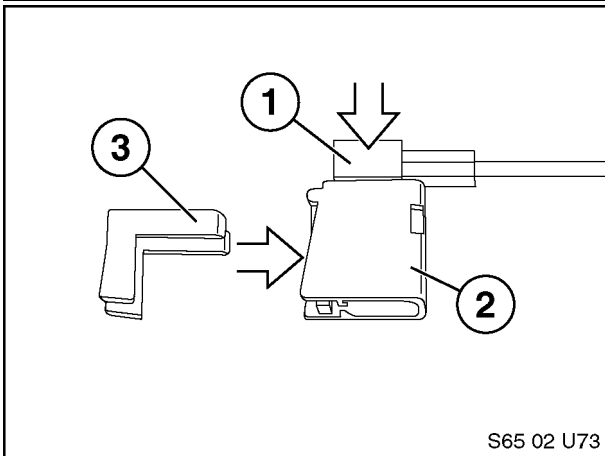

For vehicles equipped with standard audio system:

18. Connect ALC module (2) to Sirius antenna terminals. Loop excess cable if necessary (1) and secure out of the way until Sirius receiver is installed in RH location as per Sirius Receiver Installation Instructions.

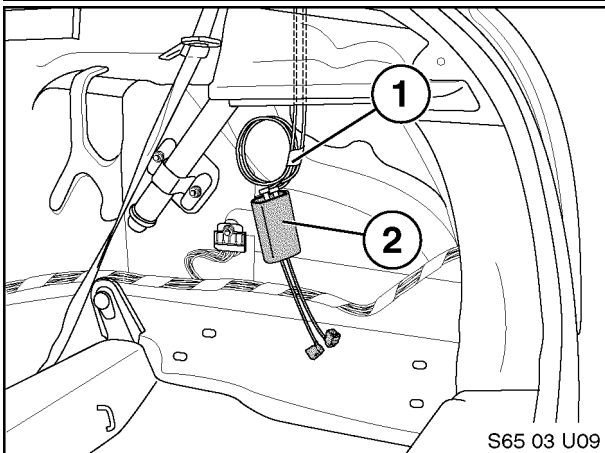

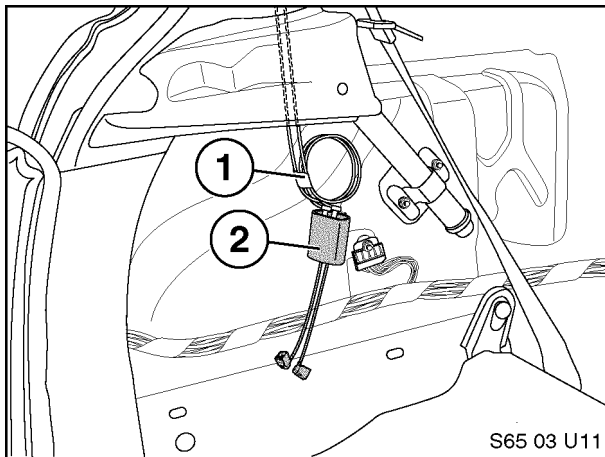
For vehicles equipped with HK Audio system:

19. Connect ALC module (2) to Sirius antenna terminals. Loop excess cable if necessary (1) and secure out of the way until Sirius receiver is installed in LH location as per Sirius Receiver Installation Instructions.

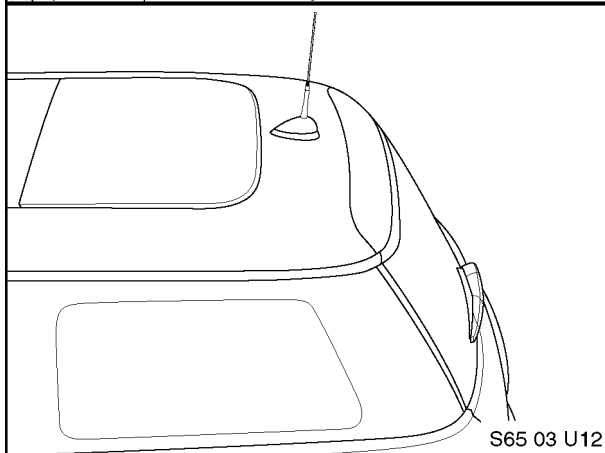

20. Apply small amount of lithium grease to mast antenna threads. Thread mast antenna into top of Sirius antenna.

21. Antenna installation is complete. Secure headliner to roof and reinstall hatch gasket.

Note: Do not re-install right and/or left rear panels as these must be removed for Sirius Receiver Installation.

22. Refer to correct Sirius Receiver Installation Manual for MINI vehicles to continue.