

ORIGINAL MINI ZUBEHÖR MONTAGEINFORMATION



ALU-HECKTRÄGER

ALUMINIUM REAR-MOUNTED CARRIER

PORTE-VÉLOS ARRIÈRE EN ALU

ALUMINIUM ACHTERDRAGER

BAKRE LASTHÅLLARE AV ALUMINIUM

PORTAPACCHI IN ALLUMINIO

SOPORTE POSTERIOR DE ALUMINIO

SUPORTE TRASEIRO DE ALUMÍNIO



Aluminium rear-mounted carrier

Installation information

Contents

General information	28
Notes	28
Safety information	28
Care instructions	30
Parts kit for aluminium rear-mounted carrier	31
Parts kit for ski/snowboard carrier	32
Unfolding aluminium rear-mounted carrier	33
Mounting number plate	33
Mounting aluminium rear-mounted carrier	34
Removing aluminium rear-mounted carrier	37
Opening and closing luggage compartment tailgate	39
Loading aluminium rear-mounted carrier with cycle	40
Unloading aluminium rear-mounted carrier	43
Mounting ski/snowboard carrier	43
Loading ski/snowboard carrier	45
Removing ski/snowboard carrier	47
Mounting cycle rack	47

EN

General information

MINI recommends using only parts and accessory products that it has checked for safety, function and suitability and approved on this basis.

Symbols used



Denotes instructions or warning information that you must heed.



Denotes instructions that draw your attention to special features.



Denotes a movement that must be performed in the direction indicated by the arrow.

- ◀ Denotes the end of the instruction.

Notes

- The installation or fitting of the lighting kit must be carried out in accordance with specific national guidelines.
- The installation of the aluminium rear-mounted carrier for MINI is illustrated for one side of the car only in some places. Proceed in the same way for the opposite side.
- Stow the second key safely and note the key number. This avoids having to replace the lock if the main key is lost.
- The installation information shows the aluminium rear-mounted carrier with lighting kit for European countries. For North America and other countries, it may not be necessary to connect the lighting kit.

Safety information

- Remove the aluminium rear-mounted carrier from the car when it is not being used in order to save fuel and for the safety of other drivers.
- Only open the luggage compartment tailgate when the platform is tilted backwards.
- The platform can be tilted to the rear when it is loaded or unloaded. Make sure there is ample space behind your car when doing this.
- Never put a cover or similar over the load while driving.
- Note the car height with loaded aluminium rear-mounted carrier.
- Remove the aluminium rear-mounted carrier before using a car wash/drive-through car wash.
- Adhere exactly to each individual operation of the installation information. If the aluminium rear-mounted carrier is not mounted correctly, it and the load can become loose from the car and endanger other drivers.
- Remember you need more space behind the car when the aluminium rear-mounted carrier is fitted.
- As the driver or owner of the car, you bear sole responsibility for the condition and secure attachment of the aluminium rear-mounted carrier.
- After the initial fitting, after driving a distance of max. 15 km check that all retaining elements of the aluminium rear-mounted carrier are firmly attached.
- The loaded aluminium rear-mounted carrier can alter the driving characteristics of the car, especially with a side wind or when braking in bends.

- Check that the aluminium rear-mounted carrier is securely attached before every journey.
Repeat the check at regular intervals during longer journeys or poor road conditions.
- Match the speed of the loaded car to the driving conditions (road conditions, road surface, side wind conditions, etc.) and the general traffic conditions.
We recommend a maximum road speed of 130 km/h.
- If you sense that the load has shifted, stop immediately and again ensure that the aluminium rear-mounted carrier is securely attached.
- When the aluminium rear-mounted carrier with lighting unit is fitted, the PDC (Park Distance Control) system switches off as long as the rear-mounted carrier is fitted to the car. After removing the rear-mounted carrier, the PDC is again ready for use. Ensure there is adequate space when reversing.
- Remove all loose parts (air pump, drink bottles, child seats, etc.) from the mounted cycles before setting off.
- Only use the rear-mounted carrier for transporting cycles, skis and snowboards. Do not transport or attach any other objects.
- The load may only protrude laterally a maximum of 40 cm beyond the rear lights.
- Heed the country-specific loading guidelines.
- If any play is detected after fitting the aluminium rear-mounted carrier, have the rear-mounted carrier lock adjusted in the workshop as described in the installation manual.
- The **total weight** of the carrier system is made up of the following weights plus the maximum load:
 - weight of the rear-mounted carrier: **12.0 kg**
 - weight of the ski/snowboard holder: **3 kg**
 - max. load:
 - per cycle rail: **15 kg**
 - ski/snowboard carrier: **7.5 kg**
- Please heed the permitted total weight and the axle loads of the car



Care instructions

We recommend cleaning the aluminium rear-mounted carrier regularly with MINI car shampoo.

Spray the lock regularly with universal protecting spray.

Spray all moving parts regularly with cycle oil or dry chain spray.

Never use cleaning agents that contain solvents, scrubbing sponges or insect removing agents. This can result in scratches or damage to the surface of the aluminium rear-mounted carrier.

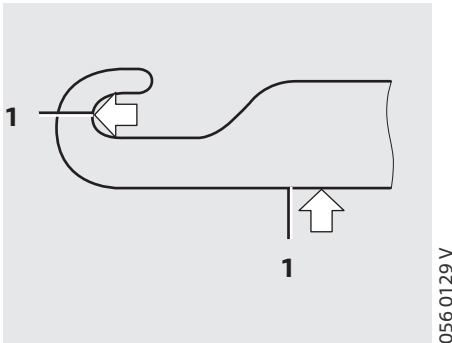

Regrease the unpainted surfaces (1) of the aluminium rear-mounted carrier support regularly with acid-free grease.

Parts kit for aluminium rear-mounted carrier

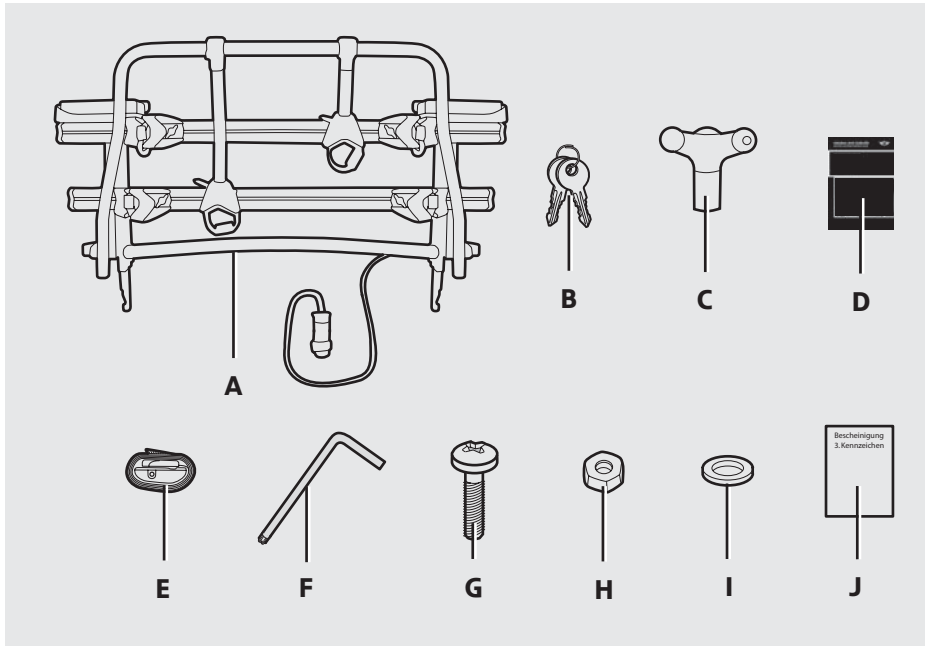

A Aluminium rear-mounted carrier

B Key (2x)

C Special key

D Installation information

E Tensioning strap (2x)

F Torx key

Only for version with lighting kit:

G Licence plate bolt (2x)

H Licence plate nut (2x)

I Shim (2x)

J Certificate for 3rd. licence plate

056 0051 V

EN

Parts kit for ski/snowboard carrier

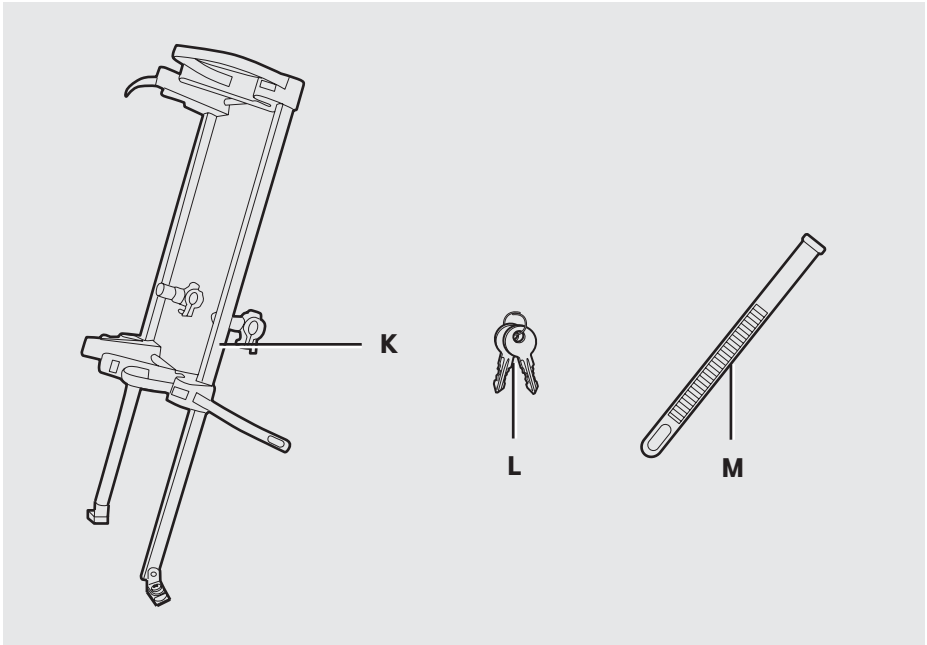

056 0088 V

K Ski/Snowboard carrier

L Key (2x)

M Long tensioning strap (4x)

Unfolding aluminium rear-mounted carrier

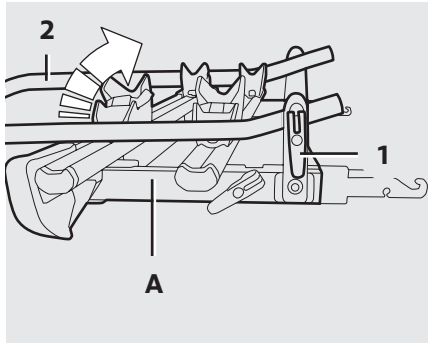

Open the catch (1) on both sides of aluminium rear-mounted carrier **A**.
Then tilt the retaining bar (2) upwards.

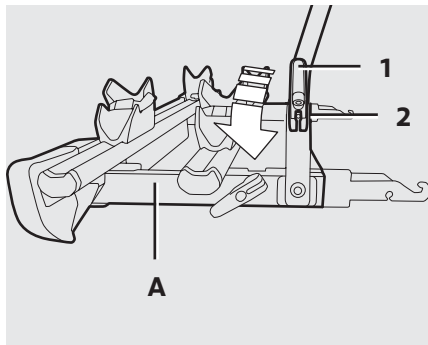

To lock the retaining bar in place, close the catch (1) again on both sides.

 Check the retaining bar. It must not move on the aluminium rear-mounted carrier.

Open the catch (1) if necessary, turn the bolt (2) to the right with Torx key **F** and close the catch (1) again.

Repeat the process if necessary. ◀

Mounting number plate

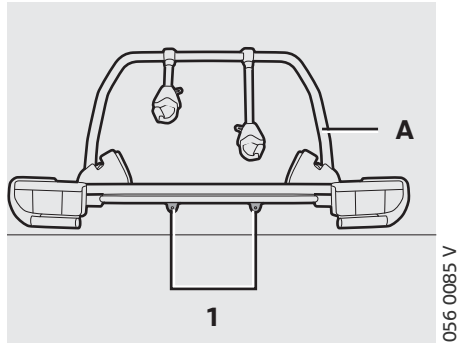

Place aluminium rear-mounted carrier **A** on a flat surface in order to fit the license plate.

The licence plate is attached to the brackets (1) with supplied bolts **G**, shims **I** and nuts **H**.

 If necessary, a license plate holder can also be placed under the licence plate. ◀

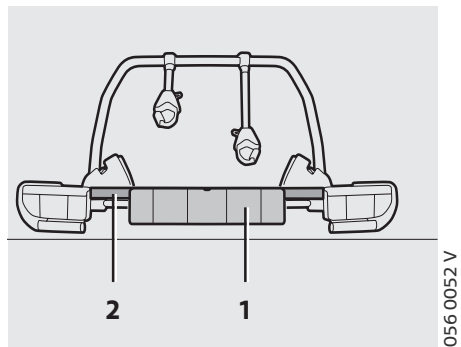

Attach the licence plate (1) so that it lies flush with the top edge of the aluminium rail (2).

Mounting aluminium rear-mounted carrier

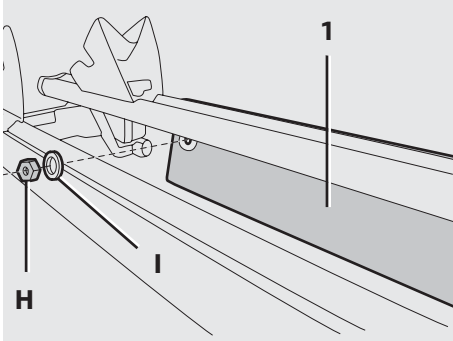

056 0053 V

Screw on the licence plate (1) with nuts **H** and shims **I** on aluminium rear-mounted carrier **A**.

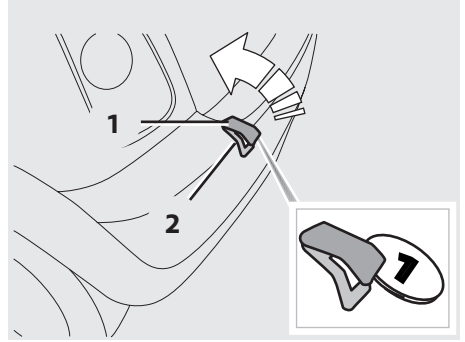

056 0054 V

There is a recess at the bottom right of the cover cap (1).

Remove the cover caps (1) on both sides of the frame (2) using a coin in the recess if necessary.

Stow the cover caps (1) in a suitable place in the car.

Only for aluminium rear-mounted carrier with light

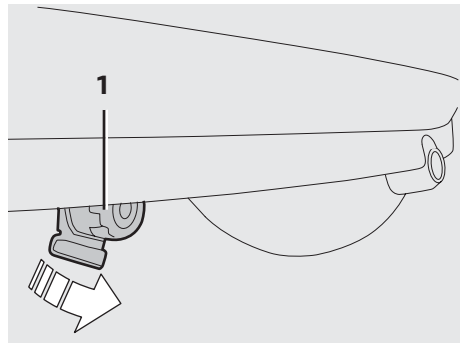

056 0055 V

Swivel the power socket (1) downwards.

For all cars

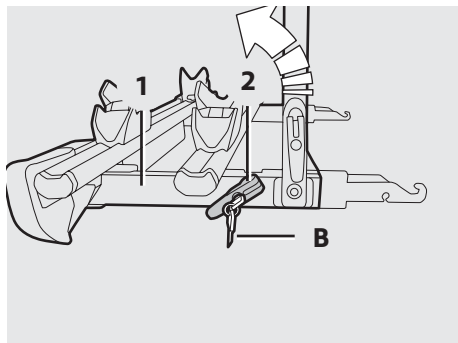

Before fitting aluminium rear-mounted carrier **A** on your car, the platform (1) must be tilted to the rear.

To do this, insert key **B** into the lock of the catch (2) and turn it to the left.

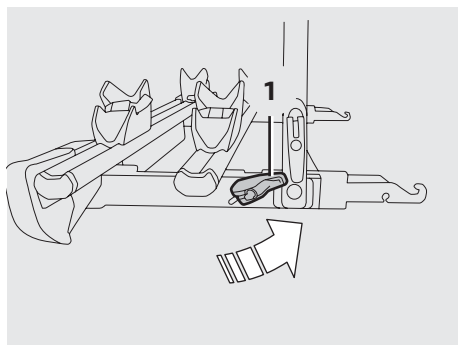

Now swivel open the catch (1) on both sides. If key **B** is in the way, remove it.

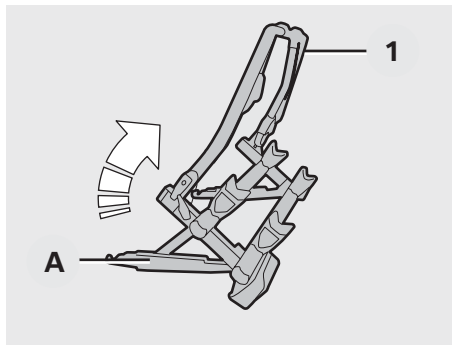

Tilt the platform (1) of aluminium rear-mounted carrier **A** to the rear.

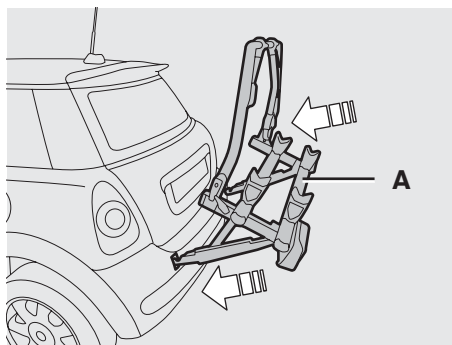

While tilting it slightly forwards, insert aluminium rear-mounted carrier **A** first into the left mounting and then into the right mounting in the recesses for the aluminium rear-mounted carrier.

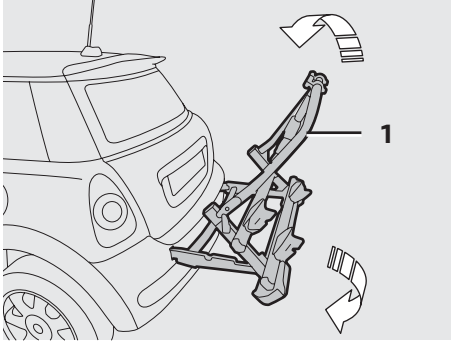

Slowly bring the aluminium rear-mounted carrier **A** into a horizontal position.

Then tilt the platform (1) of aluminium rear-mounted carrier **A** towards the front again.

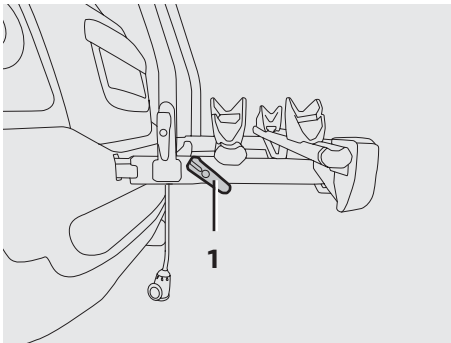

Close the catches (1) on both sides.

 Always close the lock of the right catch.

Remove key **B** and stow it in a suitable place in the car.

If any play can be detected after fitting aluminium rear-mounted carrier **A**, take the aluminium rear-mounted carrier lock to the workshop for adjustment as described in the installation manual. ◀

Only for aluminium rear-mounted carrier with light

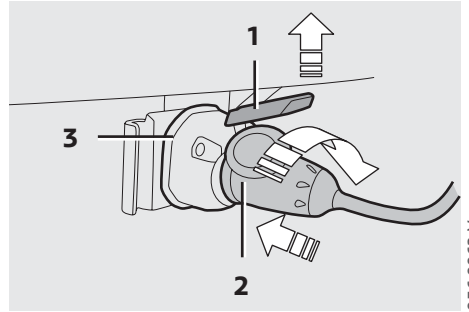

Lift the cover (1), insert the plug (2) into the socket (3) and click it in place with a quarter turn to the right.

Removing aluminium rear-mounted carrier

 You must unload aluminium rear-mounted carrier **A** before removal. ◀

Only for aluminium rear-mounted carrier with light

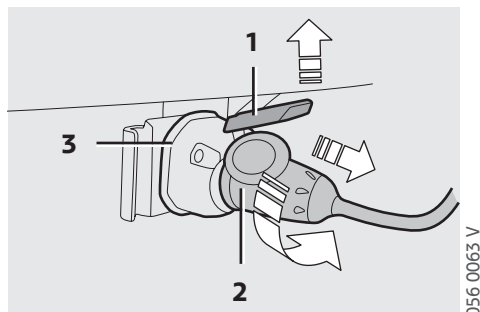

Lift the cover (1), release the plug (2) with a quarter turn to the left and pull it out of the socket (3).

For all cars

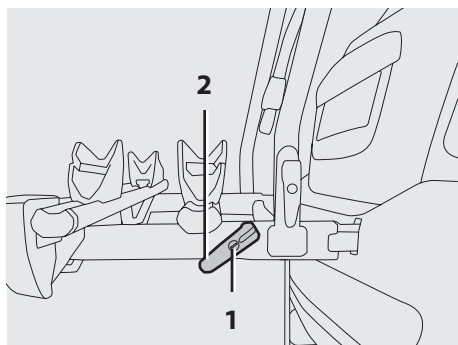

Insert key **B** into the lock (1) of the catch (2) and turn it to the left. Swivel open the catch (2) on both sides. If key **B** is in the way, remove it.

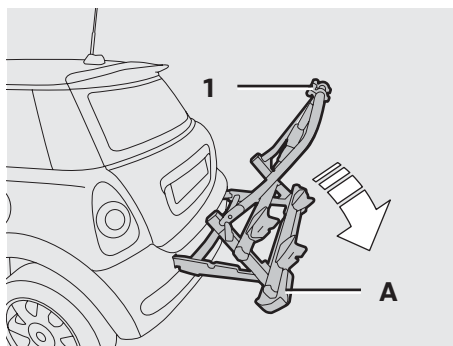

Tilt the platform (1) of aluminium rear-mounted carrier **A** to the rear.

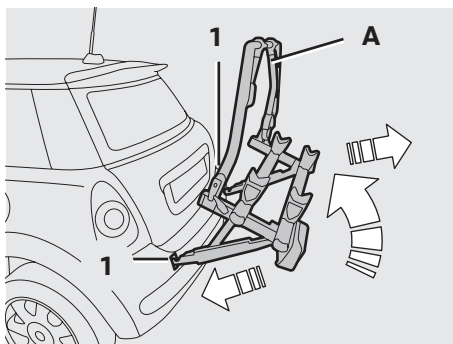

First push aluminium rear-mounted carrier **A** forwards slightly in the direction of the car and tilt it forwards towards the luggage compartment tailgate. In this position, carefully remove alu rear-mounted carrier **A** from the rear-mounted carrier recesses (1) and store.

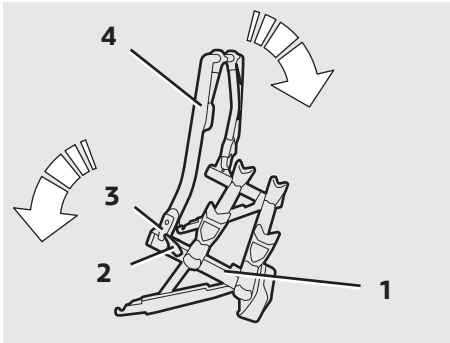

For space-saving stowage of aluminium rear-mounted carrier **A**, tilt the platform (1) of aluminium rear-mounted carrier **A** forwards and engage the catch (2), open the catch (3) on both sides and tilt the retaining bar (4) to the rear.

Only for aluminium rear-mounted carrier with light

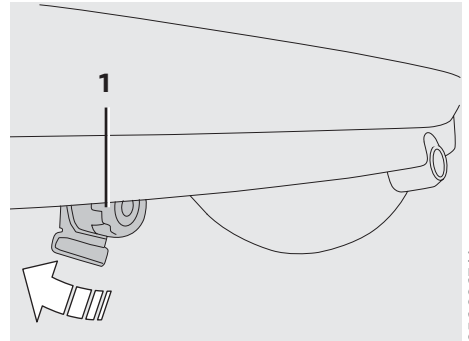

Swivel the power socket (1) upwards behind the rear apron.

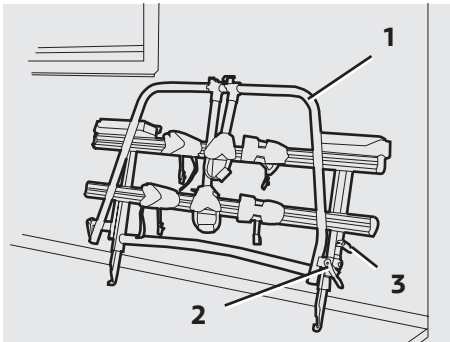

To lock the retaining bar (1) into place, close the catch (2) again on both sides.

Close the catch (3) on both sides. Remove key **B** and stow it in a suitable place.

For all cars

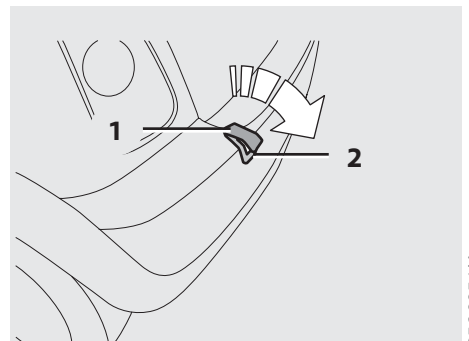

On both sides, clip the cover caps (1) from top to bottom onto the frame (2).

Opening and closing luggage compartment tailgate

 The luggage compartment tailgate can be opened with loaded and with unloaded aluminium rear-mounted carrier **A**. ◀

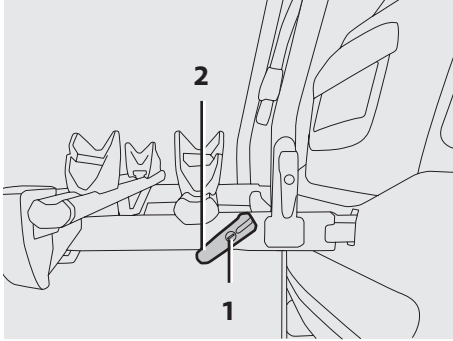

Insert key **B** into the lock (1) of the catch (2) and turn it to the left. Swivel the catch (2) upwards. If key **B** is in the way, remove it.

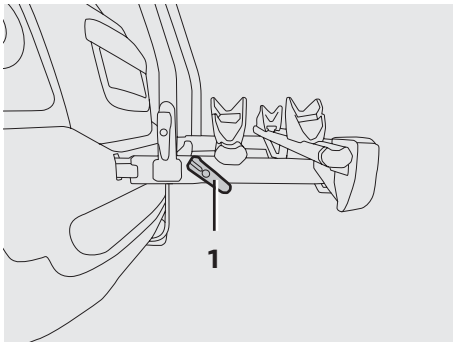

Swivel the catch (1) upwards.

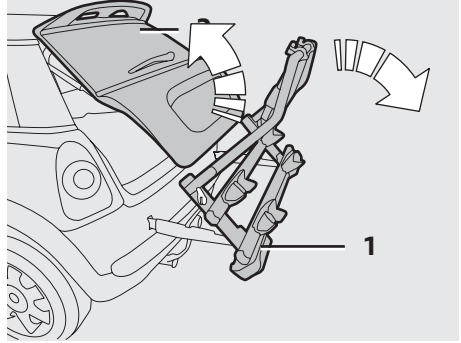

Tilt the loaded or unloaded platform (1) of aluminium rear-mounted carrier **A** slowly backwards to the end stop.

Make sure there is ample space behind your car when doing this.

Unlock and open the luggage compartment tailgate (2).

 Each time the luggage compartment tailgate (2) is opened or closed, make sure that aluminium rear-mounted carrier **A** is completely tilted to the rear. ◀

Loading aluminium rear-mounted carrier with cycle

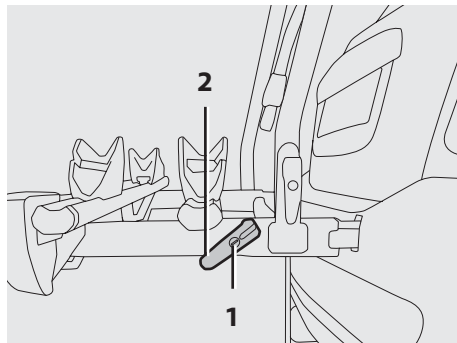

056 0064 V

 Close the luggage compartment tailgate and lock the platform accordingly in reverse order. ◀

Close the locks (1) on both sides.

 Before starting to drive, ensure that the platform of aluminium rear-mounted carrier **A** is properly locked by pulling on the tubular guide. ◀

To conclude, insert key **B** into the lock (1) of the catch (2) and turn it to the right.

Remove key **B** and stow it in a suitable place in the car.

 Always load the cycle rail close to the car first. Use the short retainer arm for attaching the cycle in this case.

Use the long retainer arm for attaching the cycle to the second cycle rail.

When transporting two cycles, make sure that the heavier cycle is always mounted on the cycle rail nearest the car. ◀

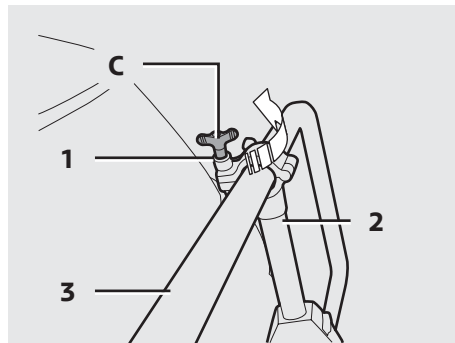

056 0070 V

Open the cover of the bolt (1), undo the bolt (1) with special key **C** and rotate the short retainer arm (2) until it is horizontal. If necessary, push the short retainer arm (2) along the tubular guide (3) in the longitudinal direction.

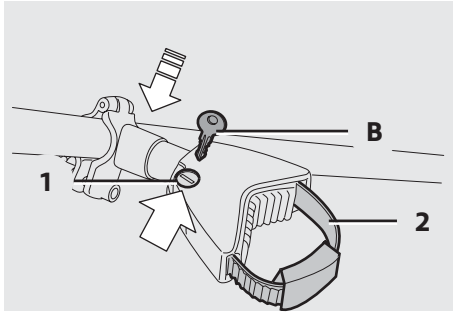

056 0071 V

Insert key **B** into the lock (1).

Turn key **B** to the left to unlock the gripping belt (2).

 When the lock (1) is open, you cannot remove key **B** of aluminium rear-mounted carrier **A**. ◀

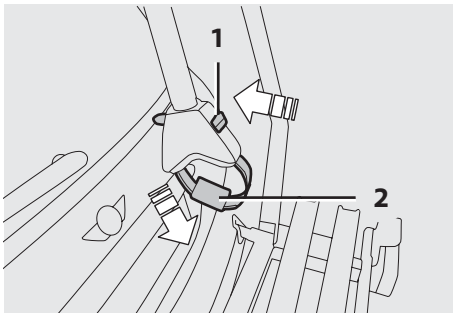

056 0072 V

Press the pushbutton (1) and pull out the gripping belt (2) at the same time.

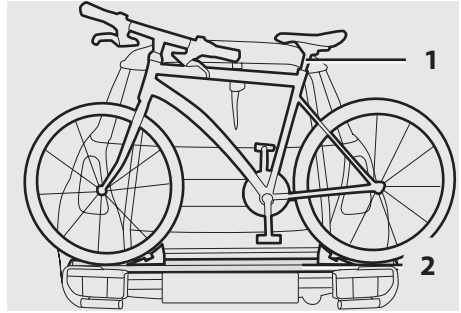

056 0073 V

 Before mounting, it may be necessary to turn the cycle handlebars by a quarter turn to the left as shown in the picture. Rotate the pedal closest to the car to the top. ◀

Place the cycle (1) on the cycle rail (2) and align it centrally.

 Ensure that no parts jut out from the load. Otherwise this can lead to collisions when opening and closing the luggage compartment tailgate. ◀

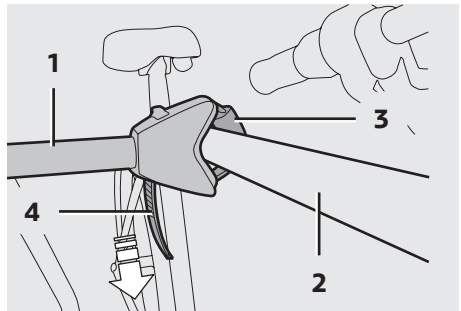

056 0074 V

Position the short retainer arm (1) at a suitable location on the cycle frame (2).

 Attach the retainer arm (1) to the highest possible location on the cycle frame or saddle post. If necessary, push the retainer arm (1) along the tubular guide to the left or right. ◀



The padding (3) can be removed for very thick frames.

Wrap the gripping belt (4) around the cycle frame and push the end in again. Pull the gripping belt (4) tight.

 The gripping belt is locked by inserting key **B** in the lock and turning it to the right.

The locks on the spacers must always be locked. Stow key **B** in a suitable place. ◀

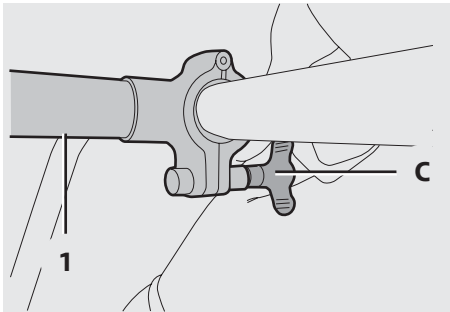

Tighten the bolt of the short retainer arm (1) with special key **C**.

Close the bolt cover.

 Stow special key **C** in a suitable place. ◀

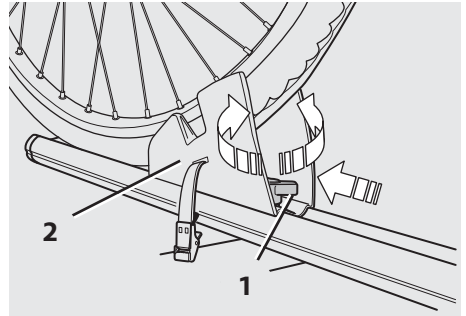

Undo the wing bolts (1) of the wheel shoes (2).

Push the wheel shoes (2) onto the cycle wheels.

Tighten the wing bolts (1) on the wheel shells (2) by hand.

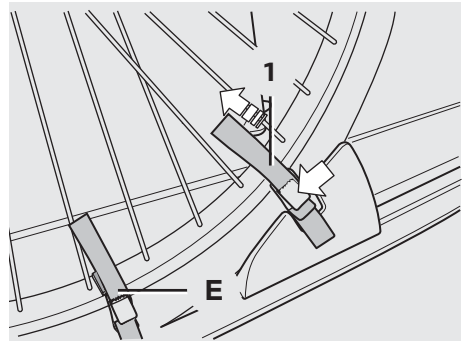



Secure the cycle wheels with the tensioning straps (1).

Stretch tensioning strap **E** around the rim of the front wheel and the outer end of the rail of aluminium rear-mounted carrier **A**.

 Place the fasteners of the clamping belts on the sides of the cycle wheels, not on the rim. Load the aluminium rear-mounted carrier with a second cycle. The fitting corresponds to that of the first cycle. ◀

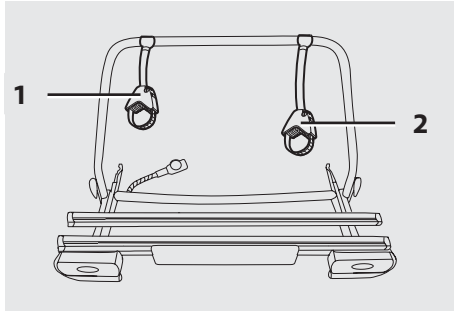
Unloading aluminium rear-mounted carrier



 Unload aluminium rear-mounted carrier **A** in reverse order. ◀

Push both the short retainer arm (1) and, if necessary, the long retainer arm (2) to one side to ensure the best possible rear view.

Mounting ski/snowboard carrier

 To mount ski/snowboard carrier **K**, remove the wheel shells and retainer arms beforehand. ◀

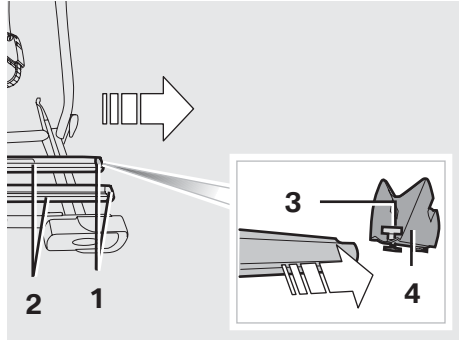

Pull the cover caps (1) out of the wheel shells (2). Then undo the bolts (3) and pull the wheel shells (4) out of the wheel rails (2).

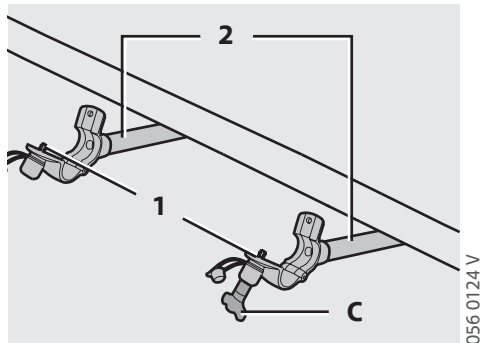

Undo the bolts (1) with special key **C**. Then tilt up the retainer arms (2) and remove them.

 Stow the retainer arms (2) so they cannot be lost. ◀

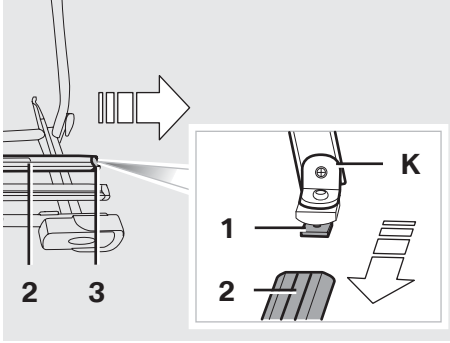

056 0091 V

Push ski/snowboard carrier **K** with the slot nuts (1) into the wheel rails (2).

Then put the cover caps (3) back on again.

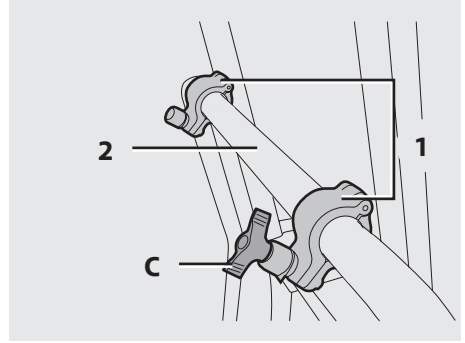

056 0094 V

Close the retainer arm brackets (1) around the tubular guide (2) of aluminium rear-mounted carrier **A**.

Lightly screw on the retainer arms (1) with special key **C**.

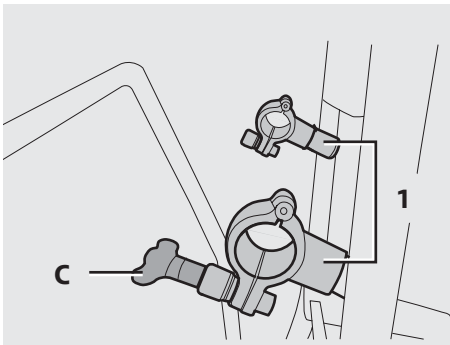

056 0093 V

Unscrew both retainer arms (1) with special key **C**. Tilt up the retainer arms (1).

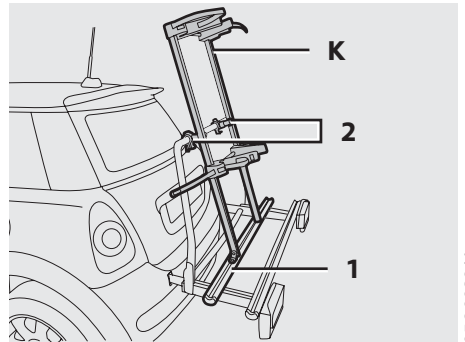

056 0089 V

Align ski/snowboard holder **K** centrally on aluminium rear-mounted carrier **A**.

Tighten the bolt connections on the wheel rail (1) and the retainer arms (2).

Loading ski/snowboard carrier

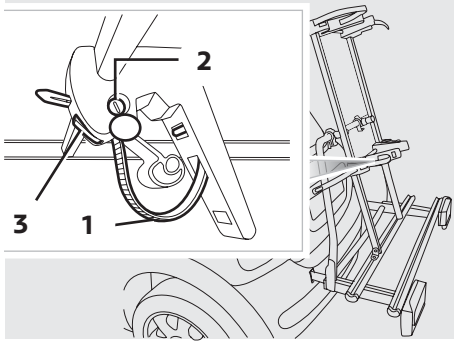

056 0095 V

Use the short tensioning straps (1) (pre-installed when shipped) for transporting skis. Open the lock cover caps and swivel them to the side. Open the lock (2) of ski/snowboard carrier **K** with key **L**.

Press the button (3) in the direction of the arrow and pull out the tensioning strap (1).

 When the lock (2) is open, you cannot remove key **L** of ski/snowboard carrier **K**. ◀

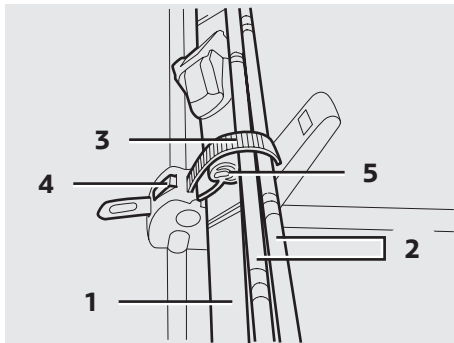

056 0096 V

Place the skis (1) and poles (2) into the holder. The ski tips point upwards. Push long tensioning strap (3) through the opening above the button (4) until the pulling lash can be grabbed.

Pull tensioning strap (3) taut. Use additional pressure on the clamping piece (5) to help pull it taut.

 The firm seating of tensioning straps must be checked at regular intervals and the tensioning strap re-tensioned if necessary. Always keep the lock closed. ◀

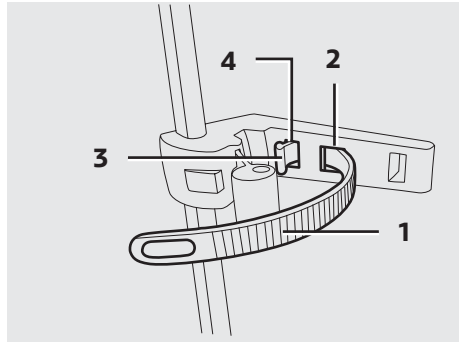

056 0097 V

To transport snowboards, you must replace the short tensioning straps (1) (pre-installed when delivered) with long tensioning straps **M**. Push the short tensioning strap (1) into the opening (2) until the end of the tensioning strap (3) can be grabbed. Pull the short tensioning strap (1) completely out by the end of the tensioning strap (3).

 To reinstall, push the tensioning strap (1) with the tothing to the inside through the opening (4) and pull it until the end of the clamping belt (3) clicks snugly into place in the opening. ◀

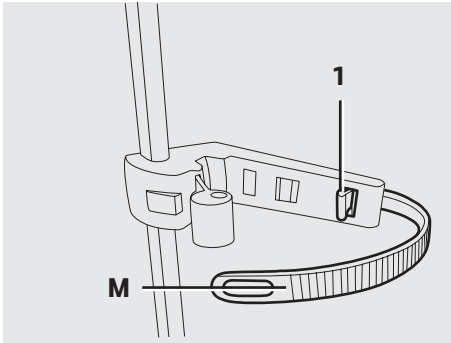

056 0098 V

 Check the firm seating of tensioning straps **M** at regular intervals and re-tension the tensioning strap if necessary. Always keep the lock closed. ◀

Push long tensioning strap **M** with the tooting to the inside through the opening (1) and pull it until the end of clamping belt **M** clicks snugly into place in the opening.

 To transport skis, you must replace long tensioning straps **M** with the short tensioning straps. ◀

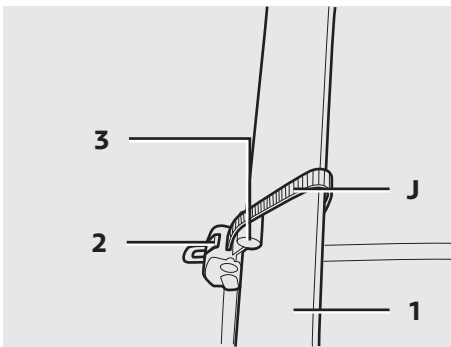

056 0099 V

Place the snowboard (1) into the holder. Push long tensioning strap **M** through the opening above the button (2) until the pulling lash can be grabbed. Pull tensioning strap **M** taut. Use additional pressure on the clamping piece (3) to help pull it taut.

Removing ski/snowboard carrier

 You must unload ski/snowboard carrier **K** before removal. ◀

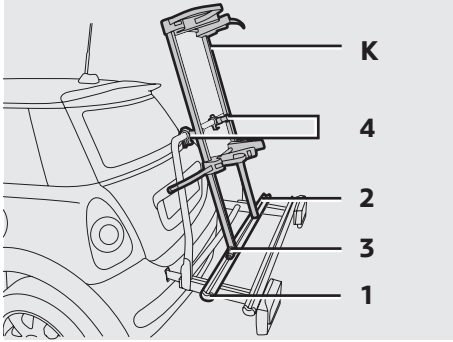

056 0123 V

Pull the cover cap (1) out of the wheel rail (2).

Undo the bolt connections (3) on the wheel rail and the bolt connections of both holders (4) with special key **C**.

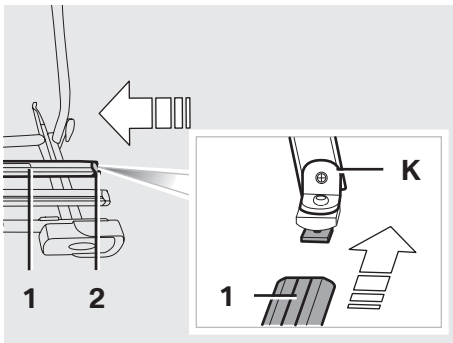

056 0125 V

Pull ski/snowboard carrier **K** out of the wheel rail (1).

Then put the cover caps (2) back on again.

Mounting cycle rack

 To assemble the wheel shells and retainer arms, you must remove ski/snowboard carrier **K** beforehand. ◀

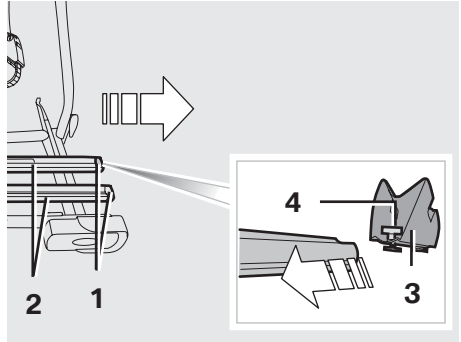

056 0126 V

Pull the cover caps (1) out of the wheel shells (2). Push the wheel shells (3) into the wheel rails (2) and tighten the bolts (4).

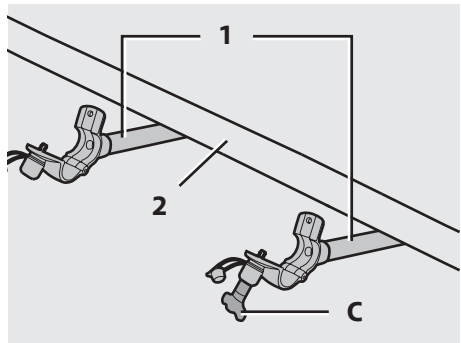

056 0127 V

Close both retainer arm brackets (1) around the tubular guide (2) of aluminium rear-mounted carrier **A**.

Tighten the retainer arms (1) with special key **C**.

EN

