

Parts and Accessories.

(from MotoringFile.com)



Airbag deactivation retrofit

MINI ONE Convertible (R52)

MINI COOPER Convertible (R52)

MINI COOPER S Convertible (R52)

MINI ONE (R50) from 07/04

MINI COOPER (R50) from 07/04

MINI COOPER S (R53) from 07/04

Retrofit kit No. 61 31 0 393 027

Installation time

The installation time is 4.5 hours, but this may vary depending on the equipment in the car.

Important information

These installation instructions are primarily designed for use within the MINI dealership organisation and by authorised BMW service companies.

In any event the target group for these installation instructions is specialist personnel trained on MINI cars with the appropriate specialist knowledge.

All work must be completed using the latest MINI repair manuals, circuit diagrams, servicing manuals and work instructions in a rational order using the prescribed tools (special tools) and observing current health and safety regulations.

To avoid unnecessary extra work and/or costs, if any installation or function problems occur, after a brief troubleshooting session (approx. 0.5 hours), an inquiry is to be sent straight away to the technical parts support via the Aftersales Assistance Portal (ASAP), quoting the chassis number, the part number of the retrofit kit and a precise description of the problem.

Do not archive the hard copy of these installation instructions since daily updates are made by ASAP.

See ASAP for details of the pictograms.

Pictograms



Denotes instructions that draw your attention to dangers.



Denotes instructions that draw your attention to special features.

◀ denotes the end of the instruction or other text.

Subject to technical modifications!

Installation information

Ensure that the cables/lines are not kinked or damaged as you install them in the car. The costs incurred as a result of this will not be reimbursed by BMW AG.

Additional cables/lines that you install must be secured with cable ties.

If the specified PIN chambers are occupied, bridges, double crimps or twin-lead terminals must be used.

All the figures show LHD cars, proceed in exactly the same way on RHD cars.

The installation is shown on a MINI Convertible. Proceed in the same way on a MINI Saloon.

After the installation work the retrofit must be programmed / coded using SSS (software service station) via the **Retrofit/CIP** path.

Ordering instructions

Check colour versions and technical equipment. The following parts are not supplied in the kits and must be ordered separately (see EPC for part number and details).

- Instrument panel trim, right **B**
- Control lamp trim **E** (for R50 and R53 only)
- Lock cylinder **F** (order using VIN)

Special tools required

None

Contents

Section	Page
1. Parts list.....	4
2. Preparations.....	5
3. Installation and cabling diagram.....	6
4. Connection diagram.....	7
5. To install and connect the wiring harness.....	8
6. Concluding work and coding.....	11
7. Circuit diagram.....	12

1. Parts list

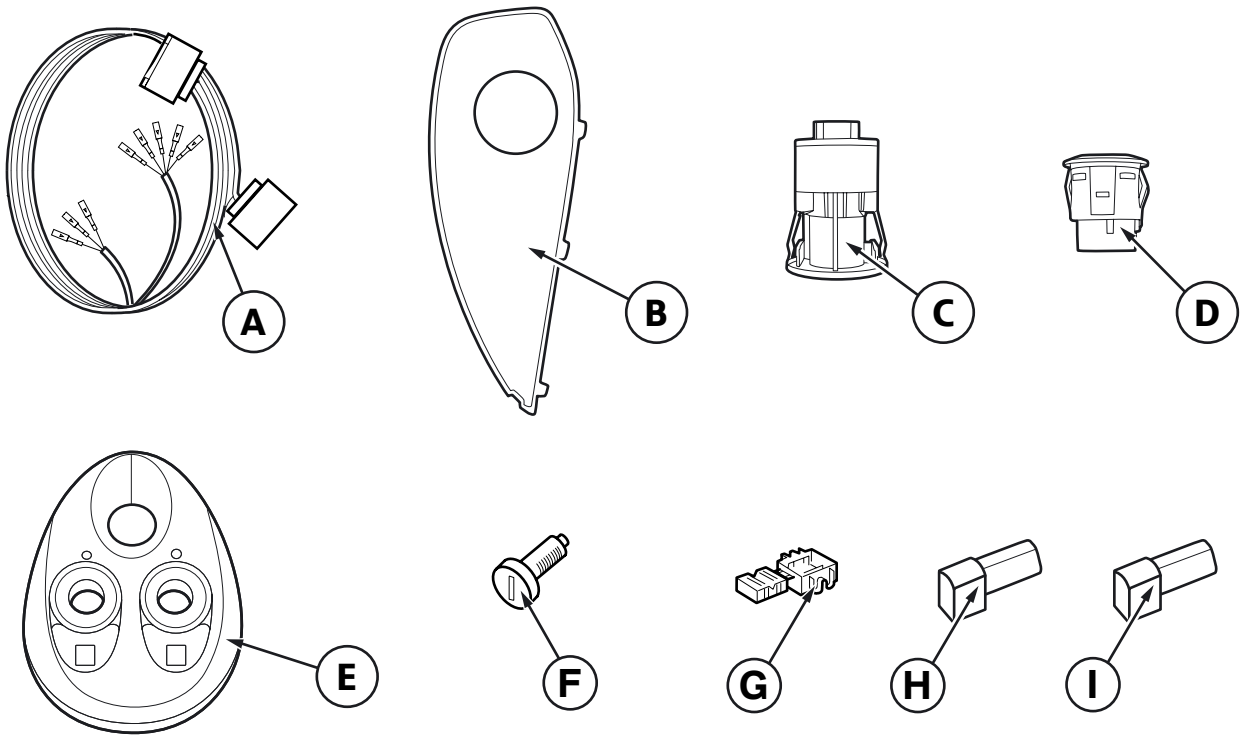

050 0469 V

Legend

- A Wiring harness
- B Trim for instrument panel, right (not included in the retrofit kit)
- C Airbag deactivation switch
- D Airbag deactivation control lamp
- E Control lamp trim (for R50 and R53 only, not supplied in the retrofit kit)
- F Lock cylinder (not supplied with the retrofit kit)
- G Miniature connector
- H GE 3-pin plug
- I SW 3-pin plug

2. Preparations

	TIS No.
Conduct a brief test	---
Disconnect the negative pole of the battery	12 00 ...
The following components must be removed first of all	
Front centre console	51 16 200
Rear centre console	51 16 216
Door sill strip, front right (interior)	51 47 000
A pillar trim on the right	51 43 201
Top windscreen panel trim (R52 only)	51 13 128
Sun visor and hinge bracket on both sides	51 16 080
Interior mirror	51 16 060
Glove compartment	51 16 360
Lower the front headlining slightly (R50/R53 cars)	---
Front passenger seat	52 13 000

3. Installation and cabling diagram

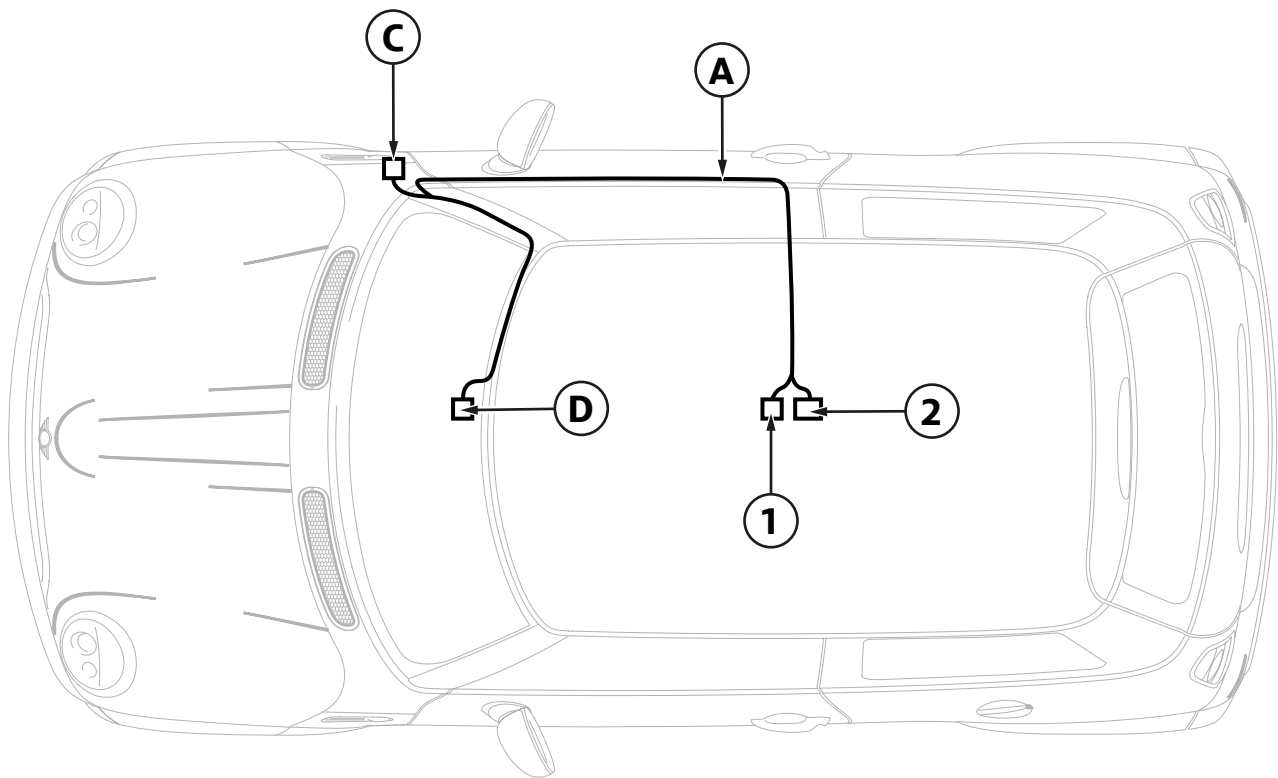

050 0468 V

Legend

- A Wiring harness
- C Airbag deactivation switch
- D Airbag deactivation control lamp

- 1 Earth post **X13230**
- 2 Airbag control module

4. Connection diagram

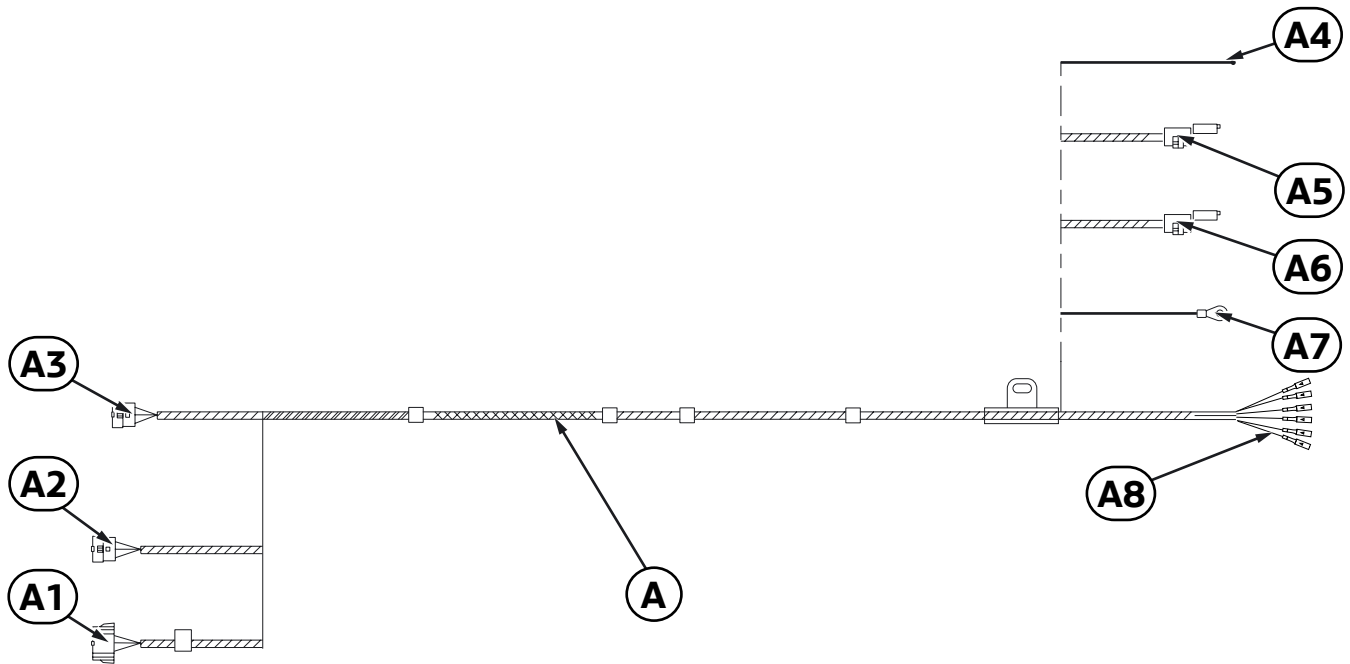

050 0470 V

Item	Description	Signal	Cable colour / Cross-section	Connection location in the car	Abbreviation / Slot
A	Wiring harness	---	---	---	---
A1	SW 6-pin plug	---	---	To airbag deactivation switch C	X11558
A2	SW 8-pin plug	---	---	To airbag deactivation switch C	X19565
A3	BL 6-pin plug	---	---	To airbag deactivation control lamp D	X14002
A4	Open cable	Terminal R	VIBL 0.5 mm ²	With miniature connector F from VIBL cable on plug X74 PIN 5	X8103
A5	GE 3-pin plug	---	---	To 3-pin plug H	X18069
A6	SW 3-pin plug	---	---	To 3-pin plug I	X1081
A7	Cable lug	Earth	BRSW 0.5 mm ²	To earth post X13230	---
A8	Socket contact	---	BLSW 0.5 mm ² BLBR 0.5 mm ² GE 0.5 mm ² BR 0.5 mm ² WSSW 0.5 mm ² WSBR 0.5 mm ²	To plug X74 on the airbag control module	X74 PIN 13 X74 PIN 14 X74 PIN 18 X74 PIN 19 X74 PIN 33 X74 PIN 40

5. To install and connect the wiring harness

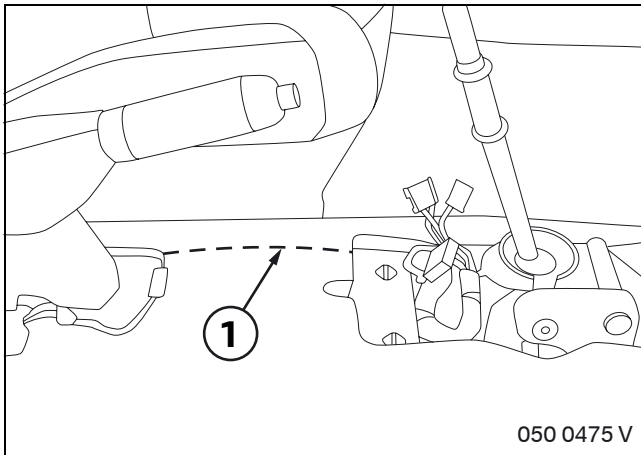

Cut the carpet along the line shown in the Figure (1) using a knife.

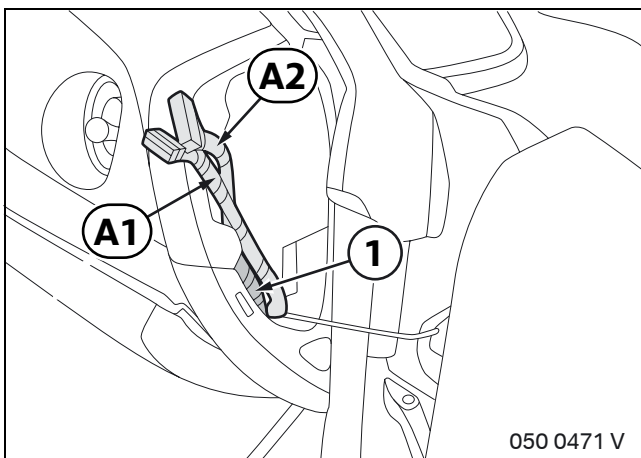

Secure branches **A1** and **A2** to the existing wiring harness (1) on the right-hand side of the instrument panel with a cable tie.

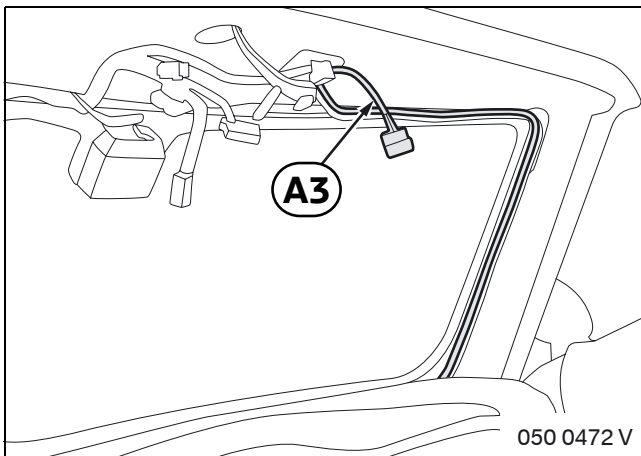

! On the R50 and R53 ensure that branch **A3** is not secured to the head airbag. ◀

Route branch **A3** along the existing wiring harness from the passenger footwell to the top windscreen panel trim to the connection location for the airbag control lamp.

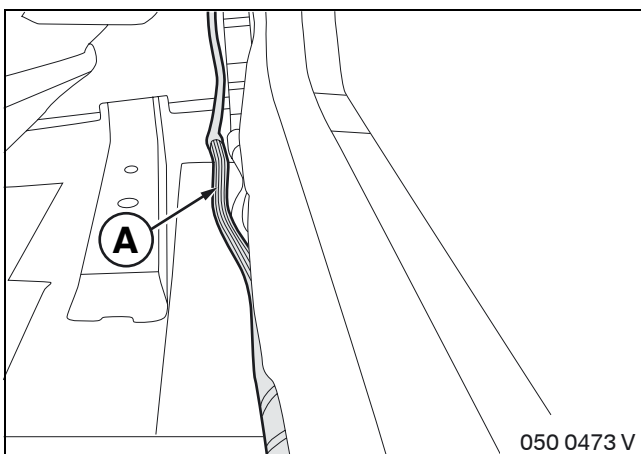

Route wiring harness **A** from the passenger footwell along the existing wiring harness towards the B pillar and then to the airbag control module.

5. To install and connect the wiring harness

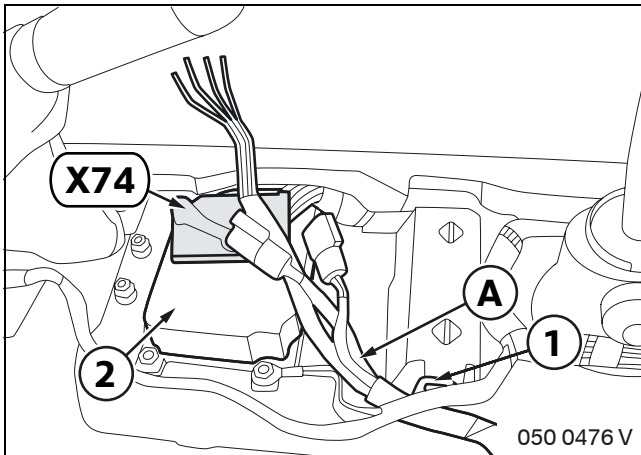

Route wiring harness **A** under the carpet from the B pillar to the airbag control module (not shown).

Secure wiring harness **A** with the holder (1) to the centre tunnel.

Disconnect the following cables from plug **X74** on the airbag control module:

- BLSW cable PIN 13
- BLBR cable PIN 14
- GE cable PIN 18
- BR cable PIN 19
- WSSW cable PIN 33
- WSBR cable PIN 40.

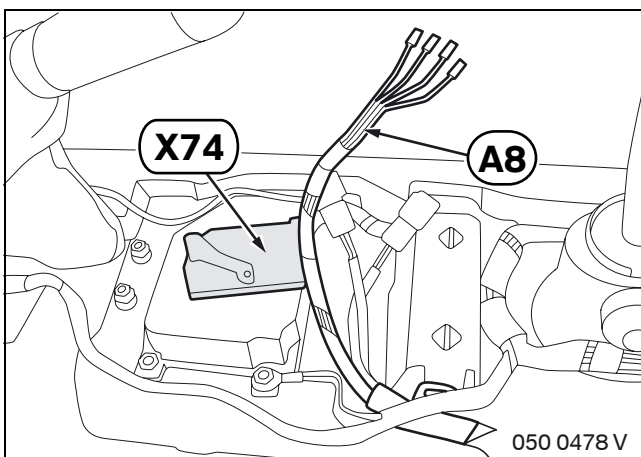

Connect branch **A8** as follows to plug **X74**:

- BLSW cable to PIN 13
- BLBR cable to PIN 14
- GE cable to PIN 18
- BR cable to PIN 19
- WSSW cable to PIN 33
- WSBR cable to PIN 40.

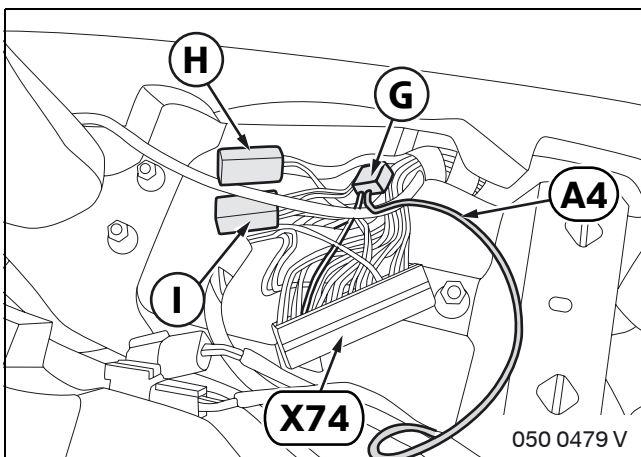

Connect the cables you disconnected earlier to plugs **H** and **I** as follows:

To plug **H**:

- WSBR cable to PIN 1
- GE cable to PIN 2
- BR cable to PIN 3

To plug **I**:

- BLSW cable to PIN 1
- BLBR cable to PIN 2
- WSSW cable to PIN 3.

Connect branch **A4** to the VIBL cable, PIN 5 in plug **X74** using a miniature connector **G**.

5. To install and connect the wiring harness

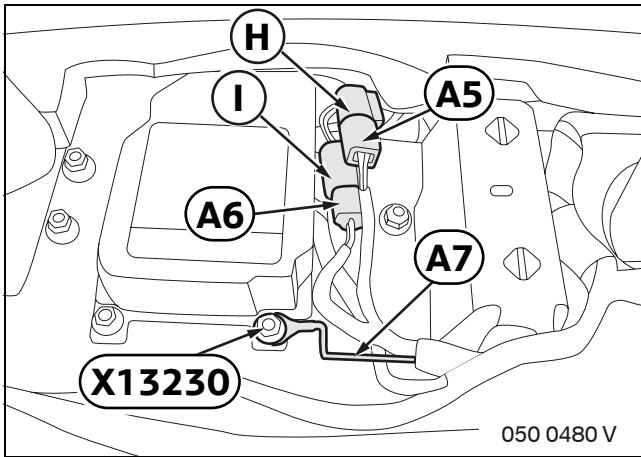

Connect plugs **H** and **I** to the cables of the same colours on branches **A5** and **A6**.

Connect branch **A7** to earth post **X13230**.

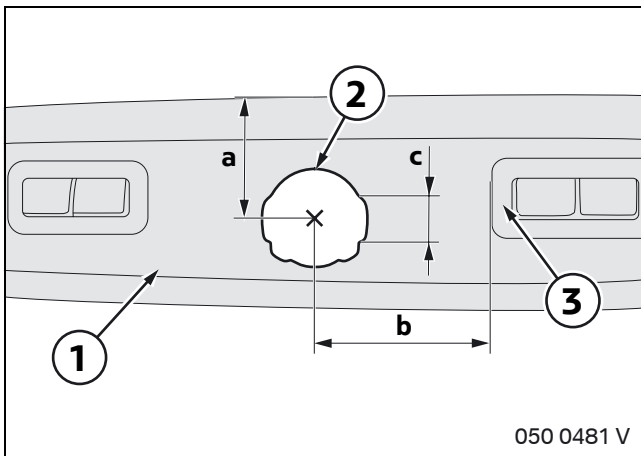

R52 cars only

Mark the centre point of the recess (2) on the windscreen panel trim (1) at a distance of $a = 33$ mm from the top and $b = 47.5$ mm from the exterior contour (3) of the switches.

Drill the holes with a diameter of 26 mm. Cut the lugs with $c = 10$ mm using a file.

Check and refile the recess (2) using the airbag deactivation control lamp **D** (not shown).

Clip the airbag deactivation control lamp **D** (not shown) into the windscreen panel trim (1).

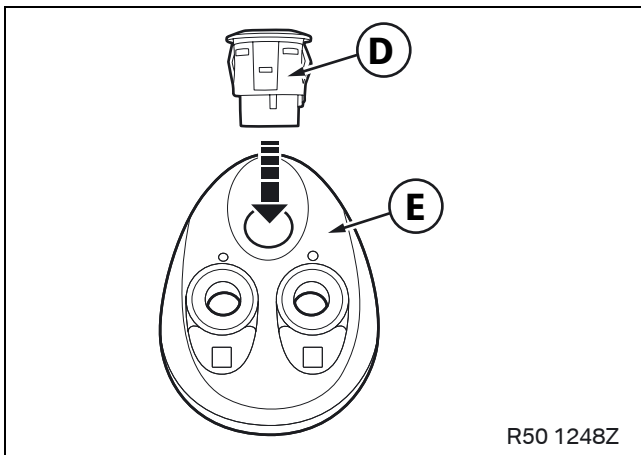

R50 and R53 cars only

Clip the airbag deactivation control lamp **D** into the trim **E**.

All cars:

Connect branch **A3** to the airbag deactivation control lamp (not shown).

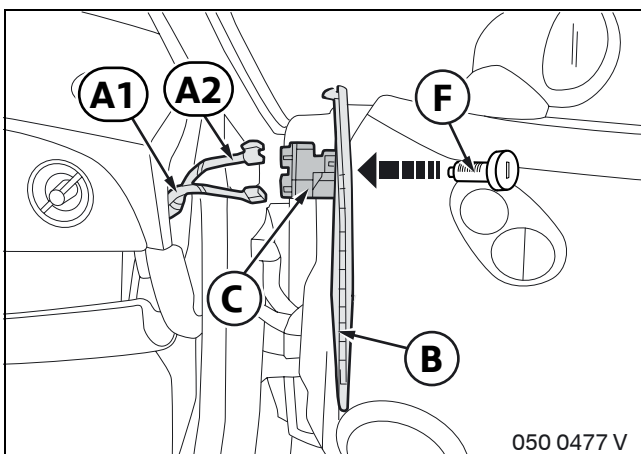

Install the lock cylinder **F** into the airbag deactivation switch **C**.

Lock the airbag deactivation switch **C** into the right-hand instrument panel trim **B**.

Connect branches **A1** and **A2** to the airbag deactivation switch **C**.

Install the right-hand instrument panel trim **B**.

6. Concluding work and coding

This retrofit system does not require coding.

- Connect battery
- Conduct a brief test
- Conduct a function test
- Re-assemble the car

7. Circuit diagram

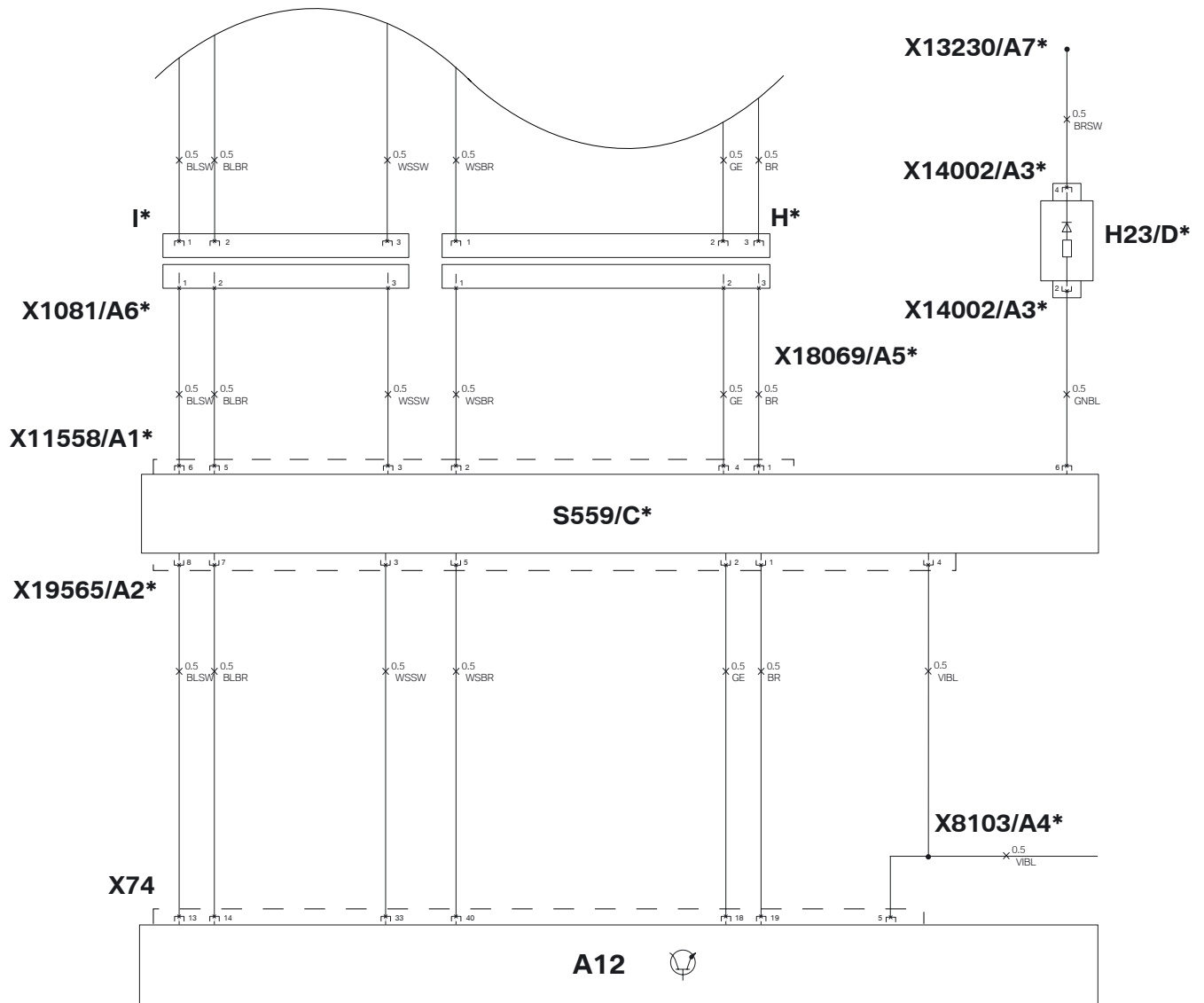

050 0482 V

7. Circuit diagram

Legend

A12	Airbag control module
H*	GE 3-pin plug
H23	To airbag deactivation control lamp D*
I*	SW 3-pin plug
S559	To airbag deactivation switch C*
X74	BL 50-pin plug, to airbag control module
X1081	SW 3-pin plug A6*
X11558	SW 6-pin plug, A1* , to airbag deactivation switch C*
X13230	Earth post, A7*
X14002	BL 6-pin plug, A3* , to airbag deactivation control lamp D*
X18069	GE 3-pin plug, A5*
X19565	SW 8-pin plug, A2* , to airbag deactivation switch C*
X8103	Open cable end, A4*

All the designations marked with an asterisk (*) apply only to these installation instructions or this circuit diagram.

Cable colours

BL	Blue
BR	Brown
GE	Yellow
GN	Green
SW	Black
VI	Violet
WS	White