

# Original MINI Accessory. Installation Instructions.



## Start button retrofit

**MINI ONE and COOPER (R 50)**

**MINI Convertible (R 52)**

**MINI COOPER S (R 53)**

<b>Retrofit kit No.</b>	61 13 0 403 350
	61 13 0 404 638
	61 13 0 404 641
	61 13 0 404 643
	61 13 0 404 644
	61 13 0 404 645
	61 13 0 404 646
	61 13 0 404 648
	61 13 0 404 649
	61 13 0 404 738
	61 13 0 404 739
	61 13 0 404 740
	61 13 0 404 741
	61 13 0 404 742
	61 13 0 404 743
	61 13 0 404 744
	61 13 0 404 745
	61 13 0 404 746
	61 13 0 405 110
	61 13 0 405 111
	61 13 0 405 112
	61 13 0 405 113

## Installation time

The installation time is approx. 0.75 hours, but this may vary depending on the equipment in the car.

## Important information

These installation instructions are primarily designed for use within the MINI dealership organisation and by authorised BMW service companies.

In any event the target group for these installation instructions is specialist personnel trained on MINI cars with the appropriate specialist knowledge.

All work must be completed using the latest MINI repair manuals, circuit diagrams, servicing manuals and work instructions in a rational order using the prescribed tools (special tools) and observing current health and safety regulations.

**To avoid unnecessary extra work and/or costs, if any installation or function problems occur, after a brief troubleshooting session (approx. 0.5 hours), contact the following:**

- 1. Either your national sales company or your regional office or**
- 2. The Support team via the Aftersales Assistance Portal (ASAP) using the optional technical parts support application.**

**Specify the chassis number and the part number of the installed retrofit kit and give a precise description of the problem.**

Do not archive the hard copy of these installation instructions since daily updates are made by ASAP.  
See ASAP for details of the pictograms.

#### Pictograms



Denotes instructions that draw your attention to special features.

◀ Denotes the end of the instruction or other text.

Subject to technical modifications!

Print out section 8 and hand it to the customer.

#### **Installation information**

Ensure that the cables/lines are not kinked or damaged as you install them in the car. The costs incurred as a result of this will not be reimbursed by BMW AG.

Additional cables/lines that you install must be secured with cable ties.

If the specified PIN chambers are already used, bridges, double crimps or twin-lead terminals must be used.

All the figures show LHD cars, proceed in exactly the same way on RHD cars.

#### **List of special equipment**

The following special equipment must be taken into consideration when installing the retrofit kit:

**SA 494**    Seat heating system

**SA 609**    Professional navigation system

#### **Special tools required**

None

## Contents

Section	Page
1. Parts list.....	4
2. Preparations.....	5
3. Connection diagram.....	6
4. Installation and cabling diagram.....	7
5. To install and connect the wiring harness.....	8
6. Concluding work and coding.....	10
7. Circuit diagram.....	11
8. To use the start button.....	12

## 1. Parts list

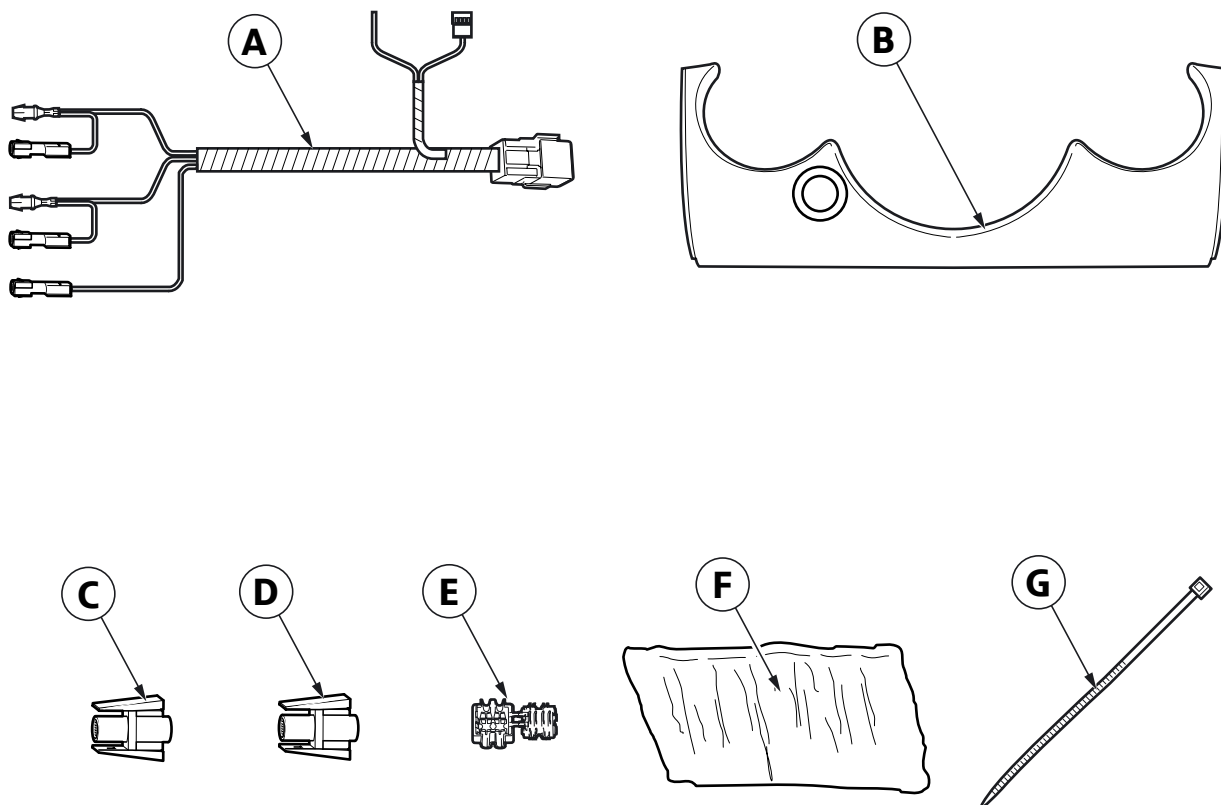

R50 1235 Z

### Legend

- A Wiring harness
- B Décor trim with start button
- C 1-pin BL socket casing
- D 1-pin SW socket casing (2x)
- E Miniature connector
- F Protective strip
- G Cable tie 200 x 3 mm (10x)

## 2. Preparations

	<b>TIS No.</b>
Conduct a brief test	---
Disconnect negative pole of battery	12 00 ...
<b>The following components must be removed first of all</b>	
Oddments box (on the driver's side)	51 16 392
Bottom section of steering column trim	32 31 020
Décor trim for instrument panel, centre (no longer required)	51 45 060
Release the instrument holder	62 21 000/020

### 3. Connection diagram

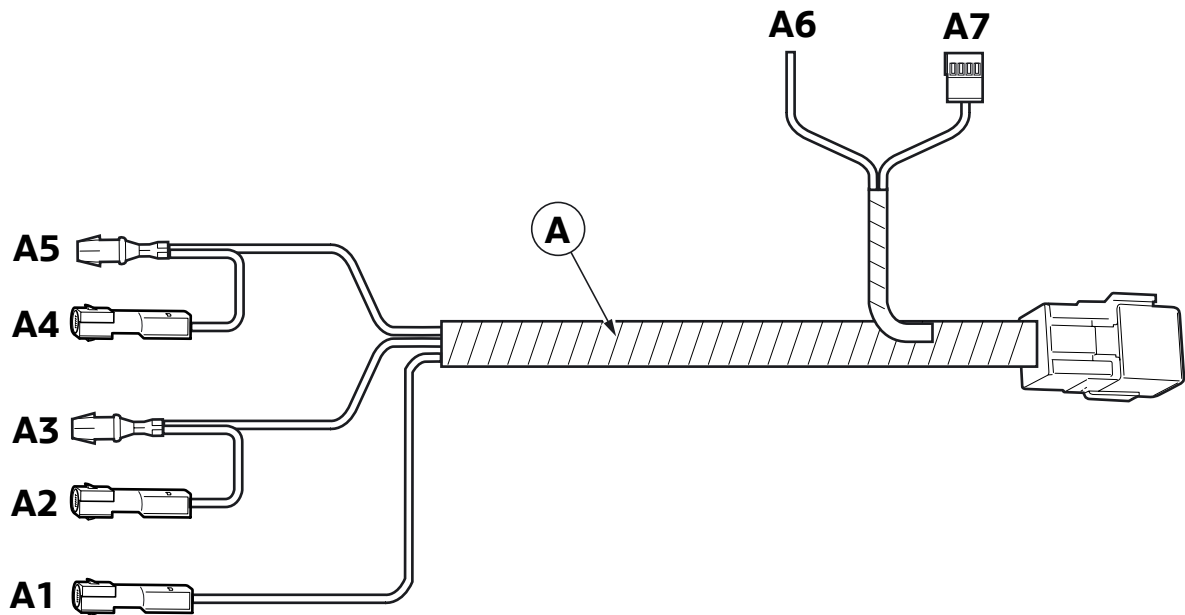

R50 1236 Z

Branch/Item	Description	Signal	Cable colour/ Cross-section	Connection location in the car	Abbreviation/ Slot
A	Wiring harness	---	---	---	---
A1	1-pin BL plug casing	S_50	SW 4.0 mm <sup>2</sup>	Using socket casing <b>C</b> to disconnected SW/BL cable from the ignition starter switch plug (11-pin SW)	X33 PIN 8
A2	1-pin SW plug casing	Terminal 15	GE 2.5 mm <sup>2</sup>	<b>Cars without SA 494 only</b> Using socket casing <b>D</b> to disconnected VI/WS cable from the ignition starter switch plug (11-pin SW) <b>Cars with SA 494 only</b> Using socket casing <b>D</b> to disconnected GN/BL cable from the ignition starter switch plug (11-pin SW)	X33 PIN 2  X33 PIN 7
A3	Socket contact	Terminal 15	GE 2.5 mm <sup>2</sup>	<b>Cars without SA 494 only</b> To ignition starter switch plug (11-pin SW) <b>Cars with SA 494 only</b> To ignition starter switch plug (11-pin SW)	X33 PIN 2  X33 PIN 7
A4	1-pin SW plug casing	Terminal 30	RT/GN 4.0 mm <sup>2</sup>	Using socket casing <b>D</b> to disconnected GN cable from the ignition starter switch plug (11-pin SW)	X33 PIN 9
A5	Socket contact	Terminal 30	RT/GN 4.0 mm <sup>2</sup>	To ignition starter switch plug (11-pin SW)	X33 PIN 9
A6	Cable open	Terminal D+	SW/GE 0.5 mm <sup>2</sup>	Using a miniature connector <b>E</b> to the instrument holder plug (26-pin SW)	X11177 PIN 6
A7	4-pin SW socket casing	---	---	To décor trim with start button <b>B</b>	---

#### 4. Installation and cabling diagram

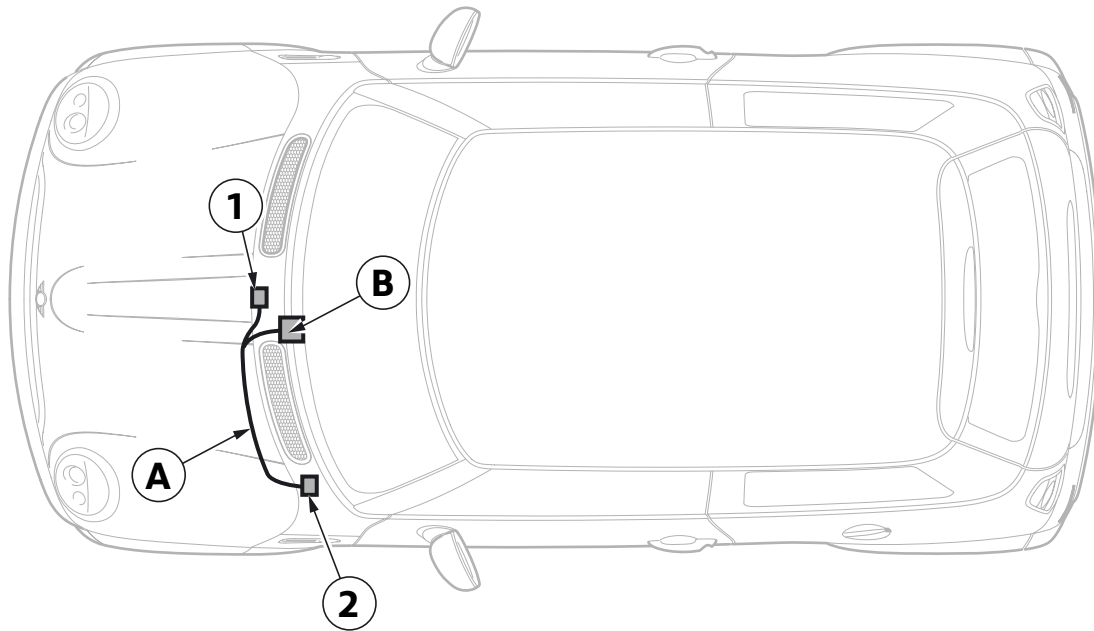

R50 1237 Z

#### Legend

- A Wiring harness
  - B Décor trim with start button
- 
- 1 Terminal D+ tap to instrument holder, plug **X11177**
  - 2 Ignition starter switch, plug **X33**

## 5. To install and connect the wiring harness

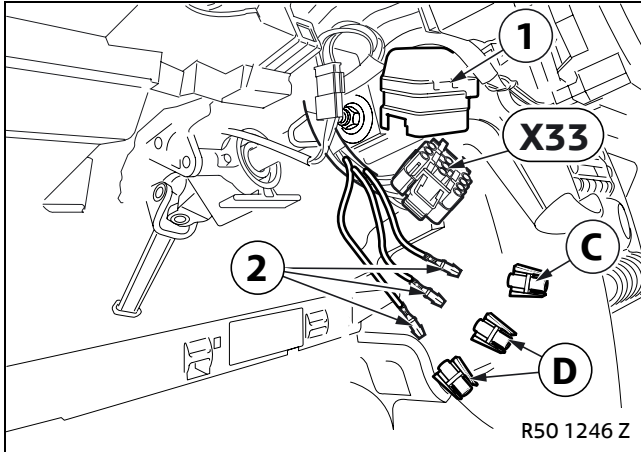

Disconnect the cables (2) as follows from plug **X33** (11-pin SW) on the ignition starter switch (1) and connect them to socket casings **C** and **D**:

- SW/BL cable from PIN 8 to socket casing **C** (1-pin BL)
- GN cable from PIN 9 to socket casing **D** (1-pin SW)

### Cars without SA 494 only

- VI/WS cable from PIN 2 to socket casing **D** (1-pin SW)

### Cars with SA 494 only

- GN/BL cable from PIN 7 to socket casing **D** (1-pin SW)

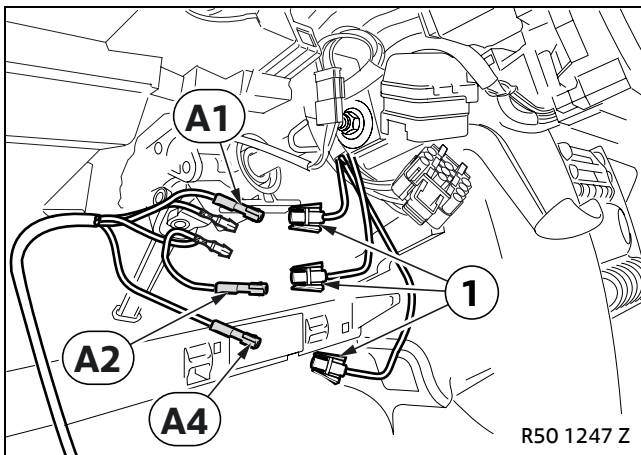

### All cars

Connect cables (1) as follows to branches **A1**, **A2** and **A4**:

- SW/BL cable to branch **A1**, SW cable
- GN cable to branch **A4**, RT/GN cable

### Cars without SA 494 only

- VI/WS cable to branch **A2**, GE cable

### Cars with SA 494 only

- GN/BL cable to branch **A2**, GE cable

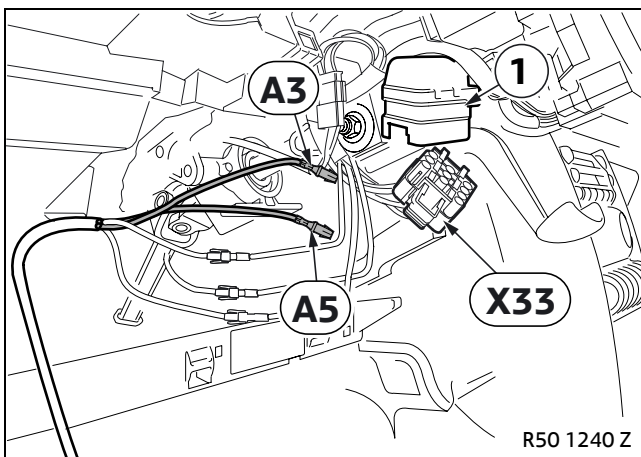

### All cars

Connect branches **A3** and **A5** to plug **X33** as follows:

- Branch **A5**, RT/GN cable, to PIN 9

### Cars without SA 494 only

- Branch **A3**, yellow cable, in PIN 2

### Cars with SA 494 only

- Branch **A3**, yellow cable, in PIN 7

### All cars

Connect plug **X33** to the ignition starter switch (1).



5. To install and connect the wiring harness

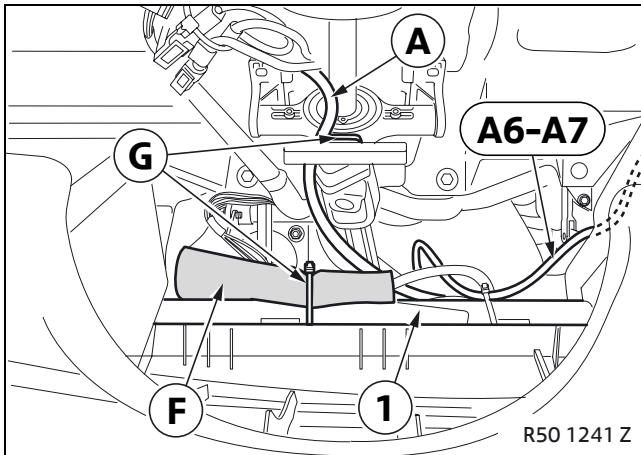

Route wiring harness **A** at an adequate safety distance from moving parts and secure it with cable tie **G**.

Wrap the relay from wiring harness **A** in safety strips **F** and secure it to the strut (1) using a cable tie **G**.

Route branches **A6** and **A7** to the instrument holder (not shown).

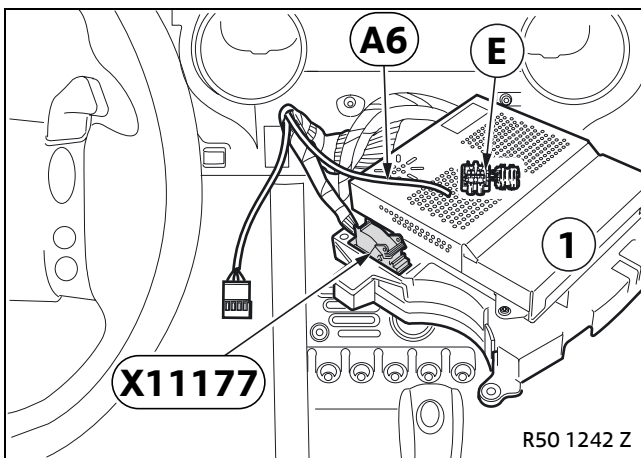

**Cars with SA 609 only**

Route branch **A6**, SW/GE cable, to plug **X11177** (26-pin SW) on the instrument holder (1).

Use a miniature connector **E** to connect branch **A6** to the SW/GE cable from PIN 6.

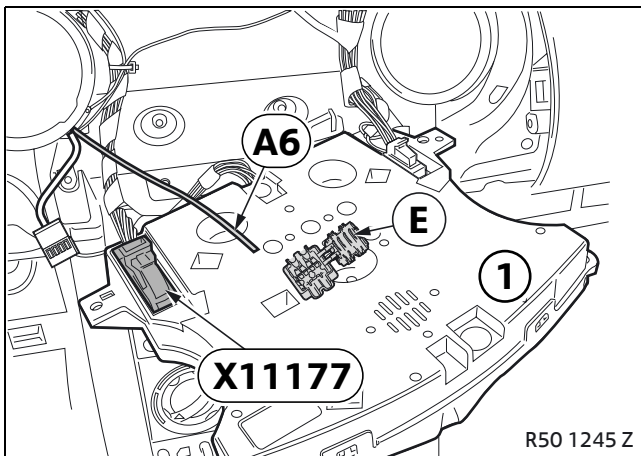

**Cars without SA 609 only**

Route branch **A6**, SW/GE cable, to plug **X11177** (26-pin SW) on the instrument holder (1).

Use a miniature connector **E** to connect branch **A6** to the SW/GE cable from PIN 6.

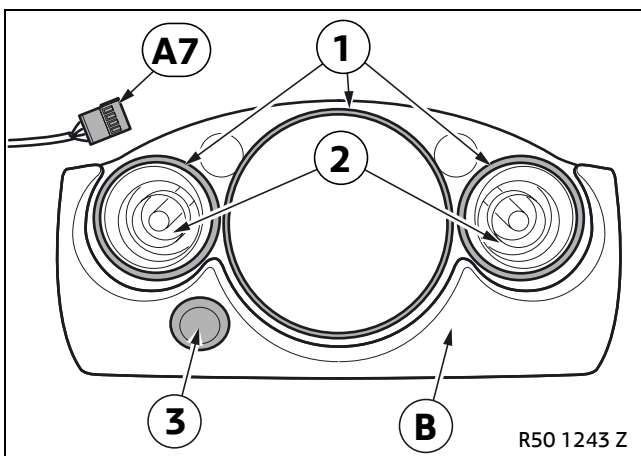

**All cars**

Modify the décor rings (1) and air vents (2) as described in TIS RA 64 22 161.

Connect branch **A7** (4-pin SW socket casing) to the start button (3).

Install the décor trim with start button **B**.

## **6. Concluding work and coding**

This retrofit system does not require coding.

- Connect the battery
- Conduct a brief test
- Conduct a function test
- Re-assemble the car

Print out section 8 and hand it to the customer.

## 7. Circuit diagram

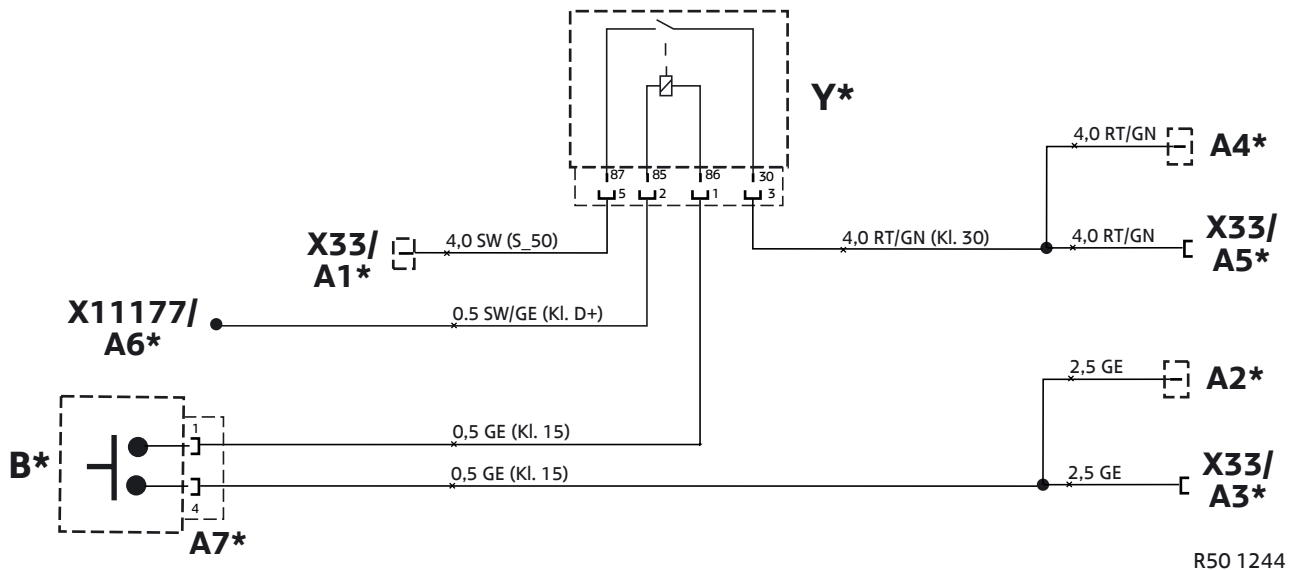

### Legend

- A1\*** 1-pin BL plug to disconnected SW/BL cable from **X33** PIN 8
- A2\*** 1-pin SW plug to the disconnected VI/WS cable (cars without SA 494), from **X33** PIN 2 or GN/BL cable (cars with SA 494), from **X33** PIN 7
- A3\*** Socket contact to **X33** PIN 2 (cars without SA 494) or socket contact to **X33** PIN 7 (cars with SA 494)
- A4\*** 1-pin SW plug to disconnected GN cable from **X33** PIN 9
- A5\*** Socket contact in **X33** PIN 9
- A6\*** Terminal D+ tap connected to SW/GE cable from **X11177** using a miniature connector **E\***
- A7\*** 4-pin SW socket casing to décor trim with start button **B**
  
- B\*** Décor trim with start button
  
- X33** 11-pin SW plug to ignition starter switch (**A1\*-A5\***)
- X11177** 26-pin SW plug to instrument holder (**A6\***)
  
- Y\*** Relay

All the designations marked with an asterisk (\*) apply only to these installation instructions or this circuit diagram.

### Cable colours

- BL Blue
- GE Yellow
- GN Green
- SW Black

## 8. To use the start button

 You can no longer start the engine in your car by turning the ignition key. Instead you have to press the start button.

Further information about starting and stopping the engine is provided in your owner's manual. ◀

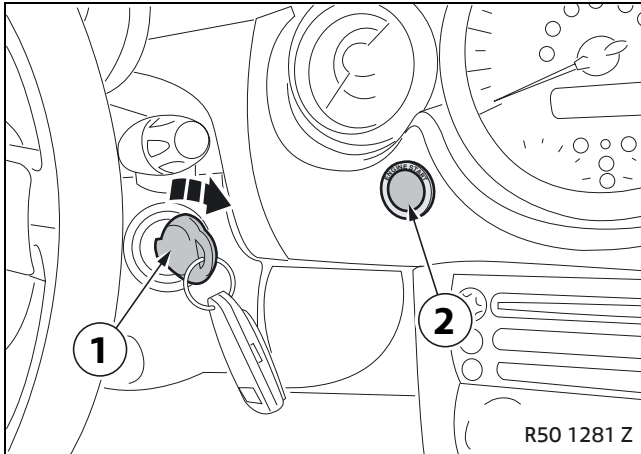

### To start a petrol engine

Switch on the ignition with your ignition key (1).

Do not press the accelerator.

Press the start button (2) until the engine has started, but for no longer than 20 seconds.

If the engine does not start after your first attempt, for example if it is very cold or hot, press the accelerator halfway down and repeat the starting procedure.

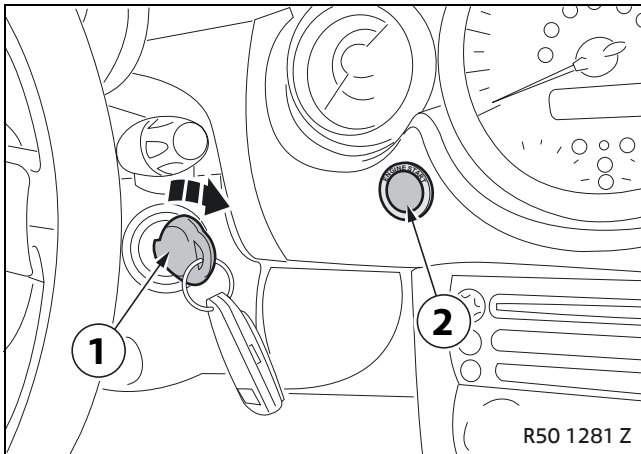

### To start a diesel engine

Switch on the ignition with your ignition key (1).

Wait until the control lamp for "Glow plugs" goes out.

Press the start button (2) until the engine has started, but for no longer than 20 seconds.

If the engine does not start after your first attempt, for example if it is very cold or hot, repeat the starting procedure.

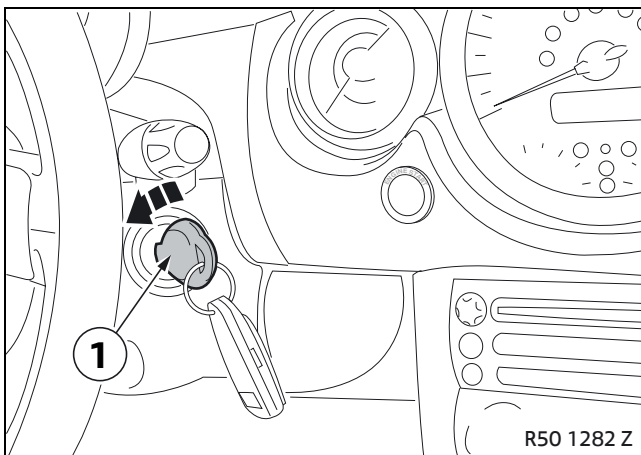

### To switch off the engine

Switch off the ignition with your ignition key (1). This switches off the engine.

 Do not remove the ignition key (1) if the car is rolling. The ignition lock would engage if you were to attempt to steer. ◀